

## INSTALLATION (FOR SLIDING DOOR)

These instructions are for installing the Door Bracket Extension Kit to a sliding door. This extension kit should fit standard portable air conditioner exhaust hose and connectors. It is important to follow the user manual that comes with your Portable Air Conditioner for safe installation and operation instructions.

### Included in this Extension Kit:

- ① Door Bracket with Exhaust Hole..... 1 Piece
- ② Door Bracket without Exhaust Hole.... 1 Piece
- ③ Door Bracket without Exhaust Hole.... 1 Piece
- ④ Screw..... 2 Pieces
- ⑤ Nut that attaches to the Screw..... 2 Pieces
- ⑥ Door Bracket Adapter..... 1 Piece

### Parts Required from Portable Air Conditioner Package (not included in this kit):

- ⑦ Plastic Hose..... 1 Piece
- ⑧ Hose Connector..... 1 Piece

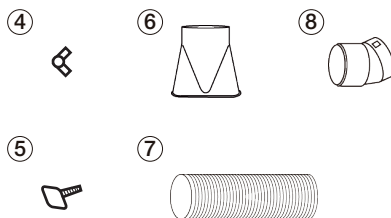
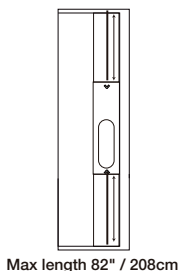
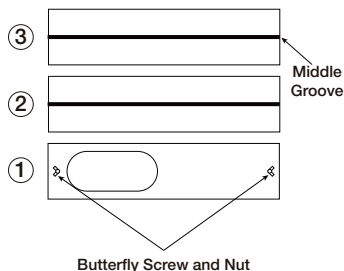

### Installation Steps:

1. Remove parts from box.
2. Loosen screw on part ① so that part ② can slide to maximum length.
3. Tighten screw to hold part ① and ② together in place.

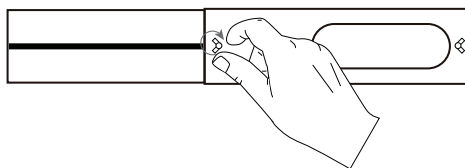
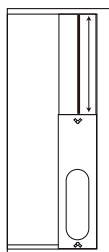

4. Locate the second screw and nut. Place the screw onto part ① and very loosely attach the nut on the other side.
5. Slide part ③ into part ① by sliding the nut into the middle groove and tighten. If the nut does not slide in, you may need to loosen the nut further to make more space for the nut to fit into the groove.

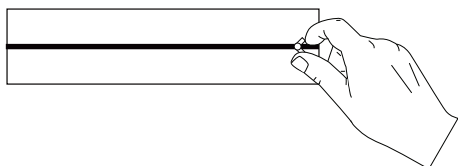

## INSTALLATION (CONTINUED)

6. Locate the plastic hose and hose connector (parts ⑦ and ⑧) from your air conditioner package (hose and hose connector are not included in this kit - they are included with your air conditioner unit). Expand the first 3-4 rings on both ends of the plastic hose.

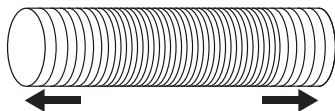

7. Attach hose to the air conditioner hose connector by rotating the hose connector until it is secured in place onto the hose.



8. Attach the door bracket adapter (part ⑥) over the hose by rotating until it is secured in place.

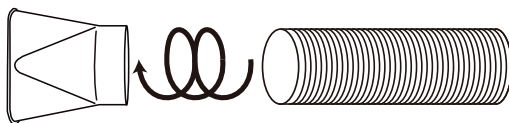

9. Press the door bracket adapter (part ⑥) of the assembled hose firmly onto the hole of part ① until it clicks into place.
10. Expand hose as needed and place assembled door kit into sliding door opening.

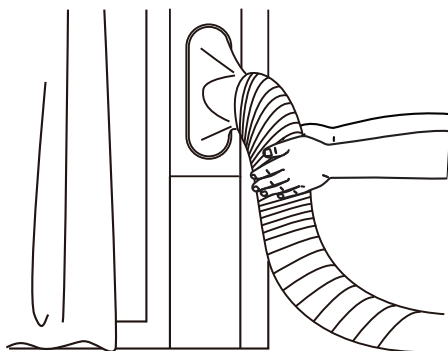
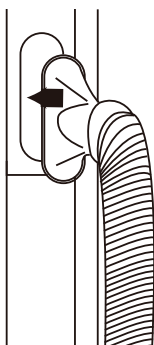

11. Attach the hose connector onto the back of your Portable Air Conditioner.