



14" HIGH VELOCITY DRUM

AIR CIRCULATOR

MODEL HVDAC

OWNER'S MANUAL"

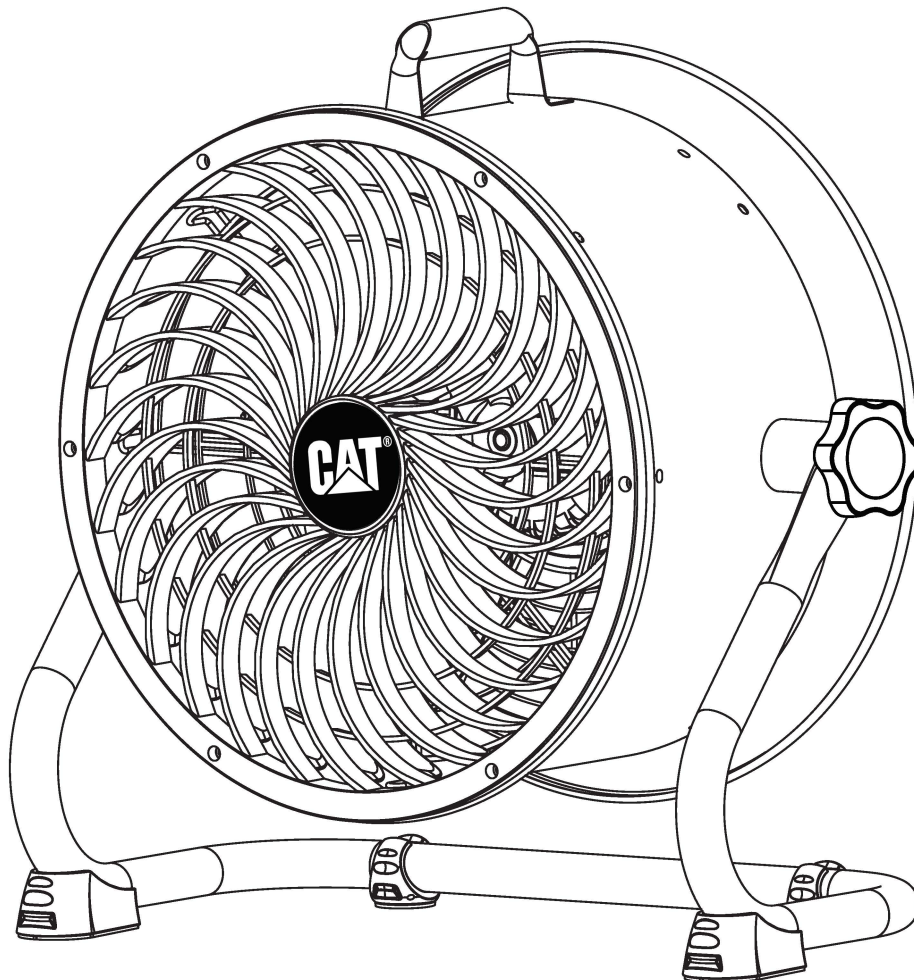

READ AND SAVE THESE INSTRUCTIONS"



SAFETY INFORMATION

Please read and understand this entire manual before attempting to assemble, operate or install the product.

WARNING

PLEASE READ AND SAVE THESE INSTRUCTIONS.

- When using electric products, basic safety precautions should always be followed to reduce the risk of fire, electric shock, and personal injury. Follow these important safety guidelines.

- Do not use this fan with any solid-state speed control device.
- Do not use an extension cord with this fan.
- Do not expose to rain. Store indoors.
- Do not use with damaged cord, plug or other parts.
- Keep cord away from heated surface.
- Do not handle plug or the fan with wet hands.
- Do not permit fingers to touch the terminals of plug when installing or removing the plug from the outlet.
- Unplug or disconnect the fan from power supply before servicing.
- After servicing, any safety device (including grilles, impeller, etc.) should be reinstalled or remounted as previously installed.
- This product is not intended for use by persons (including children) with reduced physical, sensory or mental capabilities, or lack of experience and knowledge, unless they are given supervision or instruction concerning use of the product by a person responsible for their safety. Children should be supervised to ensure that they do not play with this product.

CAUTION

- **CONSIDER YOUR WORK AREA ENVIRONMENT.** Don't use fan in damp or wet locations. Don't operate fan in presence of flammable liquids, gases like gasoline or other fuels, lighter fluid cleaners, oil-based paints, natural gas, hydrogen, coal dust, magnesium dust, grain dust, or explosive dust like powder. Do not use or store near hazardous or toxic materials.
- **USE SAFETY GLASSES.** Also use face or dust mask if work area is dusty. The operation of any fan can result in foreign objects being blown into the eyes, which can result in severe eye damage. Always wear safety goggles complying with ANSI Z87.1.
- **DON'T ABUSE CORD.** Never pull the power cord or yank it to disconnect from receptacle. To unplug, grasp the plug, not the cord. Keep cord away from heat, oil, and sharp edges. Do not pull or carry by cord, use cord as handle, close a door on cord, or pull around sharp edges or corners.
- **MAINTAIN fan.** Keep fan clean at all times. Keep dry, clean and free from moisture.
- **DISCONNECT fan** when not in use. Don't operate unit unattended.
- **NEVER** stick any object into the grille openings of the fan.
- **RETURN** for repair or to replace damaged parts if any are found to be broken or if the fan is inoperative.
- **IF** the supply cord is damaged, it must be replaced by the manufacturer, its service agent or similarly qualified persons in order to avoid a hazard.
- **THIS** appliance has a 3-prong plug. To reduce the risk of electrical shock, this plug is intended to fit in an outlet only one way.

If this does not fit the outlet, contact a qualified electrician. Do not attempt to bypass this procedure.

RULES FOR SAFE OPERATION

- Never insert fingers or any other objects through the grille guard when fan is in operation.
- Disconnect the fan when moving from one location to another.
- Disconnect the fan when removing guards for cleaning.
- Be sure fan is on a stable, flat surface when in operation.
- **DO NOT** use fan in windows. Rain and moisture may create electrical hazard.
- Do not alter the Fan's assembly.
- Be sure **FRONT** and **REAR GUARD** screw are completely screwed down in locking position before operation.

OPERATING INSTRUCTIONS

TO ADJUST AIRFLOW UPWARD OR DOWNWARD: Tilt fan head to the desired angle. This high velocity fan can be used alone or in conjunction with air conditioning. Rotating the fan head upward serves to pull air from the floor and circulate it throughout the entire room. This fan comes fully assembled. No further assembly is needed.

How to Adjust Tilt

1. Use knob to loosen tilt nut by turning counter-clockwise.
2. Adjust fan head to tilt up or down.
3. Tighten the tilt nut by turning clockwise.

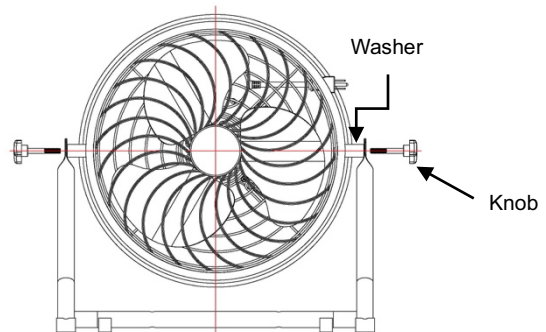

SPEED CONTROL: Rotate SWITCH to ENERGY SAVING (1), LOW (2), MEDIUM (3), AND HIGH (4)

speeds for respective air velocity. It is normal for the motor to feel warm to touch after continuous operation. This fan features a thermal cutoff that will automatically shut off should it overheat for any reason. If this happens, immediately unplug the fan from the outlet.

TO INSTALL AS WALL FAN (hardware not provided)

Secure the fan through the two holes in the stand with the screws (A) and curved washers (B) on wall.

WARNING:

- Mount fan on a wooden wall only.
- To reduce the risk of electric shock and personal injury, ensure the location for all mounting is able to support this fan.
- Total weight of fan is 14.5 lbs. (8 kg).
- This fan is recommended to be mounted by a qualified electrician.

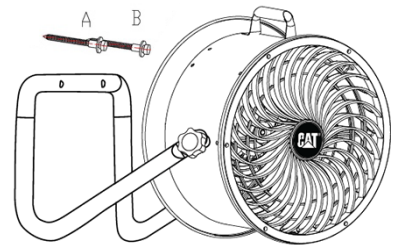

CLEANING

WARNING: Unplug from electrical supply source before cleaning.

After servicing, any safety device (including grilles and blades) must be reinstalled or remounted as previously installed:

- Use soft damp cloth to clean. Then wipe with dry cloth.
- Do not use a cleaning solution that is harmful to paints or plastics.
- Do not bend the blades.
- The motor bearings are permanently sealed and do not require additional lubrication.

WARNING: This product is not intended for use by persons (including children with reduced physical, sensory or mental capabilities, or lack of experience and knowledge, unless they have been given supervision or instruction concerning use of the product by a person responsible for their safety. Children should be supervised to ensure that they do not play with the product.

No.	Part Name
1	FRONT GRILLE
2	METAL DRUM
3	HANDLE
4	FAN BLADE
5	REAR GRILLE
6	STAND
7	MOTOR
8	RUBBER BUSHING
9	KNOB
10	AIR VOLUME SWITCH
11	SWITCH KNOB

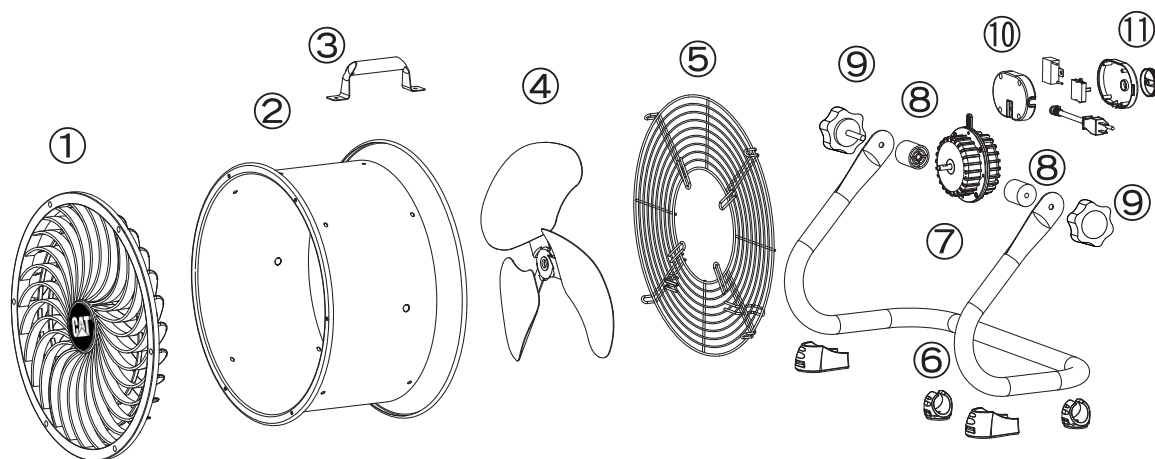



www.cat.com / www.caterpillar.com

© 2017 Caterpillar. All Rights Reserved. CAT, CATERPILLAR, BUILT FOR IT, and their respective logos, "Caterpillar Yellow," the "Power Edge" trade dress as well as corporate and product identity used herein, are trademarks of Caterpillar and may not be used without permission.

Orient Fan Co., a licensee of Caterpillar Inc.