



- BR** Instruções de utilização Aspiradores de pó a bateria
- CA** Operating instructions Battery-powered stick vacuum cleaner
- CA** Mode d'emploi aspirateur-balai sans fil
- MX** Instrucciones de funcionamiento Aspiradora vertical inalámbrica
- US** Operating Instructions Cordless Stick Vacuum Cleaner

HS19

en-US - Contents

IMPORTANT SAFETY INSTRUCTIONS	158
IMPORTANT SAFETY INSTRUCTIONS for AP01/AP02/AP03 battery, LG01/ LG02 charger, LS03 battery charger cradle (depending on the model)	164
Appliance description	170
Caring for the environment	172
References to illustrations	173
Installation and connection	173
Assembling the vacuum cleaner	173
Using the PowerUnit solo	173
Connecting the Comfort handle	173
Connecting the PowerUnit and the suction wand	173
Inserting the battery	174
Connecting the Electrobrush	174
General battery information.....	174
Charging the battery (without wall mounting)	174
Charging the battery (with wall mounting)	175
Wall mounting	175
Battery charging state indicator (while charging)	176
Battery charging state indicator (while in use)	176
Using the accessories supplied	177
Accessories holder for the suction wand	177
Multi Floor XXL Electrobrush	177
Hardfloor Care soft roller (HX HC)	177
Electro Compact handheld brush (HX SEB)	178
Additional battery (HX LA)	178
Battery charger cradle (HX LS)	178
Use	179
Switching on and off	179
Regulating the suction power	179
Carpet care function.....	179
Illuminating the work area	179
Self-standing function for short pauses in vacuuming.....	179
Maintenance	180
Optional accessories	180
Filter system	180
Activating the ComfortClean function	180
Emptying the dust container	181
Cleaning the pre-filter and fine dust filter	181

Cleaning the dust container 182

Cleaning the Electrobrush/handheld brush (depending on model) 182

Replacing the rechargeable battery 183

Fault messages..... 184

Frequently Asked Questions 185

Customer Service..... 187

Contact in case of fault 187

Warranty 187

Cleaning and care 187

Optional accessories 188

LIMITED WARRANTY - Vacuum Cleaners USA 190

en-US - IMPORTANT SAFETY INSTRUCTIONS

READ ALL INSTRUCTIONS BEFORE USING THIS APPLIANCE

This vacuum cleaner complies with all current local and national safety requirements. Improper use can lead to personal injury and damage to property.

Please read the operating instructions before using the vacuum cleaner for the first time. They contain important information on the safety, use, and maintenance of the vacuum cleaner. This prevents both personal injury and damage to the appliance.

Miele expressly and strongly advises that you read and follow the instructions in the “Installation and connection” chapter as well as the IMPORTANT SAFETY INSTRUCTIONS.

Miele cannot be held liable for injury or damage caused by non-compliance with these instructions.

Keep these operating instructions in a safe place and pass them on to any future user.

Always disconnect the vacuum cleaner from the power supply when you have finished using it, before changing any accessories, as well as for maintenance work, cleaning, and troubleshooting. Use the On/Off switch on the Comfort handle to do this.

en-US - IMPORTANT SAFETY INSTRUCTIONS

Correct use

- ▶ This vacuum cleaner is intended for cleaning flooring in domestic households and similar residential environments. This vacuum cleaner is not suitable for use on construction sites.
- ▶ This vacuum cleaner is not intended for outdoor use.
- ▶ This vacuum cleaner can be used for all normal cleaning of carpets, rugs and hard flooring.
- ▶ This vacuum cleaner is intended for use at altitudes of up to 13,000 ft (4000 m) above sea level.
- ▶ The vacuum cleaner must only be used to vacuum dry floor surfaces. Do not vacuum people or animals. Any other types of use, modifications, or alterations are not permitted.
- ▶ People with reduced physical, sensory, or mental capabilities, or lack of experience or knowledge, who are unable to use the vacuum cleaner safely, may only use the vacuum cleaner if they are supervised while using it or have been shown how to use it in a safe way and understand and recognize the consequences of incorrect operation.
- ▶ Use only as described in this manual.
Use only manufacturer's recommended attachments.

en-US - IMPORTANT SAFETY INSTRUCTIONS

Safety with children

- ▶ Children must be kept away from the vacuum cleaner unless they are constantly supervised.
- ▶ Do not allow the vacuum cleaner to be used as a toy. Close attention is necessary when used near children.
- ▶ Danger of suffocation! Ensure that any plastic wrappings, bags, etc. are disposed of safely and kept out of the reach of children.

WARNING

To reduce the risk of fire, electric shock or injury:

- ▶ Check the voltage rating of the vacuum cleaner before connecting the power cord to an electrical outlet. Your power source should correspond with the voltage rating plate located on the underside of the vacuum. Use only household AC outlets. Never use DC power sources. If you are not sure of your home's voltage supply, consult a qualified electrician. Connecting the vacuum cleaner to a higher voltage than indicated in these instructions may result in damage to the vacuum cleaner or injury.
- ▶ To reduce the risk of electric shock, this appliance has a polarized plug (one blade is wider than the other.) This plug will fit in a polarized outlet only one way. If the plug does not fit fully in the outlet, reverse the plug. If it still does not fit, contact a qualified electrician to install the proper outlet. Do not alter the plug in any way.

Technical safety

- ▶ The vacuum cleaner operates at 25.2 V.



It is classified as a Class III appliance.

This appliance is supplied by a safety extra-low voltage (SELV) power source where the voltage is low enough to protect users from the risk of electrical shock. A Class II charger is used for supplying power to charge the vacuum cleaner.

- ▶ Compare the connection data on the data plate of the charger (voltage and frequency) with that of the electricity supply. This data must match exactly. Without modifications, the charger is suitable for 50 Hz and 60 Hz.

- ▶ The electrical outlet must be rated at 15 Amps.

- ▶ Before using the vacuum cleaner and its accessories, check for any visible signs of damage. Do not use a damaged appliance.

- ▶ The Miele Multi Floor XXL Electrobrush and the Miele Electro Compact handheld brush (varies according to the model) are additional motor-driven devices designed specially for this Miele vacuum cleaner. For safety reasons, the vacuum cleaner must not be used with a different Miele Electrobrush/handheld brush or an electrobrush/handheld brush produced by another manufacturer.

en-US - IMPORTANT SAFETY INSTRUCTIONS

- ▶ Before and during use, make sure that no coarse dirt or debris is/gets trapped in the bottom of the Multi Floor XXL Electrobrush or in the bottom of the Electro Compact handheld brush (supplied depending on model).
- ▶ Store the vacuum cleaner and all accessories at an ambient temperature between 32°F and 113°F (0°C and 45°C).
- ▶ Repairs should only be performed by an authorized service agent in accordance with national and local safety regulations. Unauthorized repairs could cause injury or machine damage. Otherwise the warranty may be void.
- ▶ Repairs should only be carried out by a Miele-authorized service technician. Repairs and other work by unqualified persons can cause considerable danger to users.

Proper use

- ▶ Do not use the vacuum cleaner without the dust container, pre-filter, and fine dust filter fitted.
- ▶ Do not use with damaged cord or plug.
If appliance is not working as it should, has been dropped, damaged, left outdoors, or dropped into water, return it to a service center.
- ▶ Do not put any object into openings. Do not use with any opening blocked; keep free of dust, lint, hair, and anything that may reduce air flow.

en-US - IMPORTANT SAFETY INSTRUCTIONS

- ▶ Do not vacuum up anything which has been burning or smoking, e.g., cigarettes, ashes or hot ash, whether glowing or apparently extinguished.
- ▶ Do not use the vacuum cleaner to vacuum up any water, liquid or damp dirt. Wait until any freshly cleaned or shampooed rugs or carpets are completely dry before attempting to vacuum.
- ▶ Do not use the vacuum cleaner to vacuum toner dust. Toner, such as that used in printers and photocopiers, can conduct electricity.
- ▶ Do not vacuum up any flammable or combustible liquids or gases and do not vacuum in areas where such substances are stored.
- ▶ Never touch the Multi Floor XXL Electrobrush or Electro Compact handheld brush (varies according to the model) while it is rotating.
- ▶ Do not use the Multi Floor XXL Electrobrush or the Electro Compact handheld brush (varies according to the model) at head height.
- ▶ Do not vacuum at head height and do not let the suction get anywhere near a person's head.
- ▶ Keep hair, loose clothing, fingers, and all part of body away from openings and moving parts.
- ▶ Use extra care when cleaning on stairs.

en-US - IMPORTANT SAFETY INSTRUCTIONS

IMPORTANT SAFETY INSTRUCTIONS for AP01/AP02/ AP03 battery, LG01/LG02 charger, LS03 battery charger cradle (depending on the model)

Safety with children

- ▶ People (including children) with reduced physical, sensory, or mental capabilities, or lack of experience or knowledge, who are unable to use the LG01/LG02 charger or LS03 battery charger cradle safely, may only use this vacuum cleaner if they are supervised while using it or have been shown how to use it in a safe way and understand and recognize the consequences of incorrect operation.
- ▶ Keep the AP01/AP02/AP03 battery out of the reach of children.
- ▶ Children must be kept away from the LG01/LG02 charger and the LS03 battery charger cradle unless they are constantly supervised.

en-US - IMPORTANT SAFETY INSTRUCTIONS

Technical safety

► The AP01/AP02/AP03 battery, the LG01/LG02 charger, and the LS03 battery charger cradle are designed for use with the Miele HS19 Vacuum Cleaner. For safety reasons, the vacuum cleaner must not be used with a battery, charger, or charger cradle produced by another manufacturer.

► Only the LG01/**xx** or LG02/**xx** charger supplied or the LS03/**xx** battery charger cradle supplied or purchased as an optional accessory should be used to charge the AP01/AP02/AP03 battery.

xx stands for 01, 02, 03, 04, 05, 06, 07, or 08; these numbers identify the version of your LG01/LG02 charger and your LS03 battery charger cradle.

xx	LG01/LS03	LG02
01	AT, BE, BG, CH, CL, CZ, DE, DK, EE, ES, FI, FR, GR, HR, HU, IT, KZ, LT, LU, LV, NL, NO, PL, PT, RO, RS, RU, SE, SI, SK, TR, UA, ZA	AT, BE, BG, CH, CL, CZ, DE, DK, EE, ES, FI, FR, GR, HR, HU, IT, KZ, LT, LU, LV, NL, NO, PL, PT, RO, RS, RU, SE, SI, SK, TR, UA, ZA
02	AE, HK, IE, MY, SG, UK	AE, HK, IE, MY, SG
03	BR, CA, MX, US	BR, CA, JP, MX, US
04	AU, NZ	AU, NZ
05	CN	CN
06	KR	KR
07	JP	UK
08	IN	

► If you are using a plug adapter, make sure that it is approved for continuous operation.

en-US - IMPORTANT SAFETY INSTRUCTIONS

► Temporary or permanent operation on an autonomous power supply system or a power supply system that is not synchronized with the grid power supply (e.g., island networks, back-up systems) is possible. A prerequisite for operation is that the power supply system complies with national and local codes.

The function and operation of the protective measures provided in the domestic electrical installation and in this Miele product must also be maintained in isolated operation or in operation that is not synchronized with the grid power supply, or these measures must be replaced by equivalent measures in the installation.

► Charge and use the battery at an ambient temperature between 32°F and 113°F (0°C and 45°C).

Using the battery outside of this ambient temperature range will limit its performance.

► Stop using the AP01/AP02/AP03 battery immediately if you notice an unusual smell from it, if liquid is leaking from it, if it is significantly overheating, or if it is discolored or deformed. Dispose of the AP01/AP02/AP03 battery immediately (see safety notice “Disposing of the AP01/AP02/AP03 battery” at the end of this chapter as well as “Caring for the environment – Disposing of old batteries”).

► Batteries will deplete over time. They can then leak corrosive fluids. Avoid contact with the eyes and skin. In the event of contact, rinse thoroughly with water and seek medical advice.

en-US - IMPORTANT SAFETY INSTRUCTIONS

► The AP01/AP02/AP03 lithium-ion battery is subject to dangerous goods legislation. The user is permitted to transport the AP01/AP02/AP03 battery by road without having to observe any further requirements. Please contact Customer Service before sending the AP01/AP02/AP03 battery. Only send AP01/AP02/AP03 batteries that are undamaged and have been fully run down. Insulate the metal contacts with adhesive tape to prevent short circuits. Pack the AP01/AP02/AP03 battery in such a way that it is not able to move around inside the packaging.

Proper use

► Do not drop or throw the AP01/AP02/AP03 battery. For safety reasons, do not continue to use an AP01/AP02/AP03 battery which has been damaged.

► Keep the AP01/AP02/AP03 battery away from naked flames or other heat sources. Do not heat the AP01/AP02/AP03 battery. Do not expose the rechargeable battery to direct sunlight.

► Do not dismantle the AP01/AP02/AP03 battery.

► Do not cause a short circuit by bridging the contacts of the AP01/AP02/AP03 battery, either unintentionally or deliberately.

► Do not allow the AP01/AP02/AP03 battery to come into contact with liquids.

en-US - IMPORTANT SAFETY INSTRUCTIONS

► Disposing of the AP01/AP02/AP03 battery: remove the AP01/AP02/AP03 battery from the vacuum cleaner. Insulate the metal contacts with adhesive tape to prevent short circuits. Dispose of the AP01/AP02/AP03 battery in a municipal recycling facility. Do not dispose of the AP01/AP02/AP03 battery with your household waste.

Cleaning

► Do not immerse the vacuum cleaner or any accessories supplied with it in water.

► The Multi Floor XXL Electrobrush and the Electro Compact handheld brush (depending on the model), the PowerUnit, the suction wand, and the Comfort handle contain electrical wires. The plug connectors must not come into contact with water. Danger of electric shock. They should only be cleaned with a dry cloth.

► Clean the vacuum cleaner and accessories only with a dry or slightly damp cloth when disconnected from the power supply.

Exception:

Dust container: empty the dust container and remove the pre-filter. Clean the dust container using a mild solution of water and liquid dish soap only. Then dry the dust container carefully. Replace the pre-filter in the dust container.

en-US - IMPORTANT SAFETY INSTRUCTIONS

Accessories and parts

- ▶ Only use genuine accessories with the “ORIGINAL Miele” logo on the packaging. The manufacturer cannot otherwise guarantee the safety of the product.
- ▶ Miele can only guarantee the safety of the appliance when genuine Miele replacement parts are used. Faulty components should only be replaced with genuine Miele parts.

Transport

- ▶ The packaging material protects the vacuum cleaner from transport damage. We recommend you keep the packaging for transport purposes.

California Proposition 65

THE FOLLOWING WARNING IS REQUIRED BY THE STATE OF CALIFORNIA FOR CALIFORNIA RESIDENTS ONLY:



WARNING:

Cancer and Reproductive Harm -
www.P65Warnings.ca.gov.

SAVE THESE INSTRUCTIONS

en-US - Appliance description

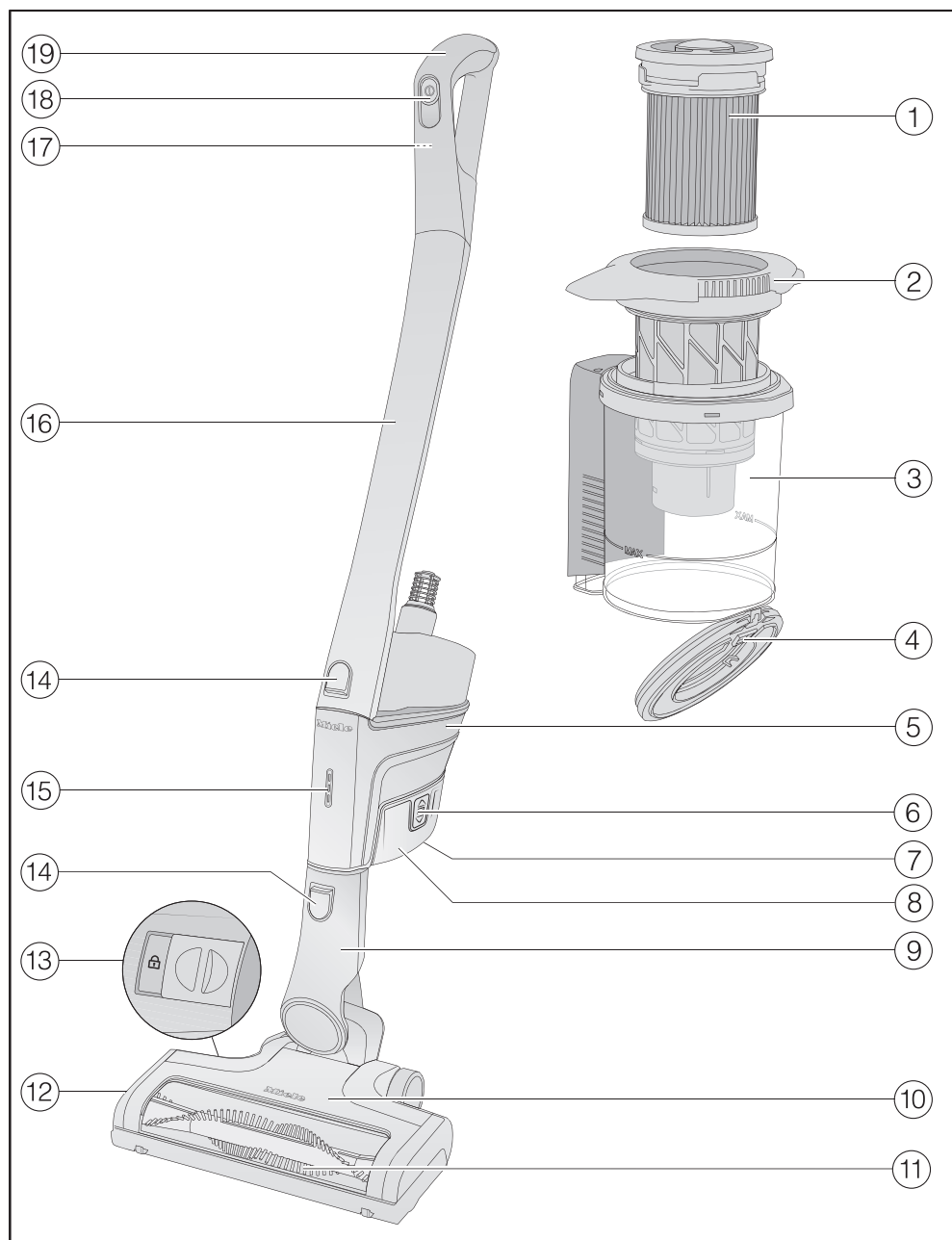

- ① Fine dust filter (HX FSF-2)
- ② Pre-filter
- ③ Dust container
- ④ Dust container flap
- ⑤ PowerUnit with a connection at the bottom for the battery, a connector at the bottom for the suction wand and Electrobrush, and a connector at the top for the suction wand and Comfort handle
- ⑥ Release buttons for battery (on both sides of the battery)
- ⑦ Charging socket (at the bottom of the battery)
- ⑧ AP01/AP02/AP03 lithium-ion battery (HX LA)
- ⑨ Electrobrush connector
- ⑩ Multi Floor XXL Electrobrush (some models feature BrilliantLight lighting)
- ⑪ Removable roller brush
- ⑫ Flap
- ⑬ Release button for opening the Electrobrush
- ⑭ Release buttons
- ⑮ Battery charging state indicator
- ⑯ Suction wand
- ⑰ Release button for Comfort handle (on the back)
- ⑱ On/Off switch with suction power selector
- ⑲ Comfort handle

Disposing of sales packaging

The packaging material protects the vacuum cleaner from transport damage. We recommend you keep the packaging for transport purposes.

The packaging materials used are selected from materials which are environmentally friendly for disposal and can therefore be recycled. Recycling the packaging material reduces the use of raw materials in the manufacturing process and also reduces the amount of waste in landfill sites. Make sure the packaging is disposed of in the proper manner for your area.

Disposal of your old appliance

Before disposing of your old appliance, remove the fine dust filter and dispose of it with your household waste.

Electrical and electronic appliances contain valuable materials. They also contain certain substances, compounds and components which are essential for the proper functioning and safe use of the equipment. Handling these materials improperly by disposing of them in your household waste can be harmful to your health and the environment. Therefore, please do not dispose of your old appliance with your regular household waste.



Instead, use the official collection and disposal points provided by local authorities, dealers or Miele, in order to dispose of and recycle electrical and electronic appliances. You are legally

responsible for deleting any personal data on the old appliance you wish to dispose of. Please ensure that your old appliance is kept away from children until removal.

Disposal of old batteries and power packs

Electrical and electronic appliances often contain batteries and power packs which must not go into household waste after use. Please remove all accessible batteries and take them to a suitable collection site where they can be collected free of charge. Batteries and power packs may contain substances which are harmful to your health and the environment.

The labeling on the battery or power pack gives further information. The crossed-out trash can means that batteries and power packs must not be disposed of with the household waste. If the crossed-out has one or more of the listed chemical symbols, it contains lead (Pb), cadmium (Cd) and/or mercury (Hg).



Old batteries and power packs contain important raw materials and can be recycled. Separately collecting old batteries and power packs facilitates handling and recycling.

References to illustrations

The illustrations referred to in the text are shown on the fold-out pages at the end of these Operating Instructions.

Installation and connection

Assembling the vacuum cleaner (Fig. 01)

You can assemble the vacuum cleaner in 2 different ways.

- You can place the suction wand either above or below the PowerUnit.

Take care to assemble the vacuum cleaner exactly as shown in the diagram.

The advantages of placing the **PowerUnit at the bottom** of the vacuum cleaner are as follows:

- secure self-standing function possible (see “Use” – “Self-standing function for short pauses in vacuuming”)
- ergonomic (reduced strain on the wrist)
- convenient cleaning of large surfaces

The advantages of placing the **PowerUnit at the top** of the vacuum cleaner are as follows:

- convenient cleaning underneath furniture
- PowerUnit can be removed quickly

Using the PowerUnit solo (Fig. 02)

The PowerUnit can be used on its own without the suction wand and Electro-brush as a quick way of vacuuming up crumbs and lint in specific areas.

Tip: This configuration is particularly suitable when using the three-piece accessory set (see “Using the accessories supplied”).

Connecting the Comfort handle (Fig. 03)

Depending on how you decide to configure your vacuum cleaner, you can connect the Comfort handle to either the suction wand or the PowerUnit.

- Push the Comfort handle down on to the suction wand connection from above until it audibly clicks into place (left image detail).
- Slide the Comfort handle along the guide line on the dust container handle and down on to the PowerUnit connector from above until it audibly clicks into place (right image detail).
- Switch off the vacuum cleaner using the On/Off switch on the front of the Comfort handle if you want to separate the sections.
- Press the release catch and remove the Comfort handle by pulling upward (Fig. 04).

Connecting the PowerUnit and the suction wand (Fig. 05)

Depending on how you decide to configure your vacuum cleaner, the suction wand is located either above or below the PowerUnit.

- Slide the suction wand along the guide line on the dust container handle and down on to the PowerUnit connector from above until it audibly clicks into place (left image detail).

- Push the PowerUnit connector down on to the suction wand from above until it audibly clicks into place (right image detail).
- Press the release catch to separate the individual sections from each other (Fig. 06).

Inserting the battery (Fig. 07)

- Push the battery along the guide lines until it audibly clicks into place in the PowerUnit.
- If you want to separate the sections again, press both release catches at the side of the battery to remove the battery (Fig. 08).

Connecting the Electrobrush (Fig. 09)

Depending on how you decide to configure your vacuum cleaner, you can connect either the PowerUnit connector or the suction wand connector to the Electrobrush.

- Insert the connector down into the Electrobrush from above until it audibly clicks into place.
- To separate the individual sections from each other, press the release catch on the Electrobrush and pull the connector out of the Electrobrush (Fig. 10).

General battery information

The rechargeable battery is supplied not fully charged. Charge the battery completely before using it for the first time. Allow approximately 4 hours for this. To activate the battery, it is essential to place it in the PowerUnit when charging it for the first time.

Once the battery is fully charged, the battery charging state indicator on the PowerUnit switches off to conserve energy.

The maximum charging capacity is only achieved once the battery has been charged and run down five times.

A full charge provides enough power for 14 minutes if the vacuum cleaner is used at the maximum power level in its fully assembled state.

However, if you use the PowerUnit solo and select the minimum power level, you can vacuum for up to 60 minutes at a time.

Charging the battery (without wall mounting) (Fig. 11)

You can store the vacuum cleaner upright and charge the battery directly.

Before charging the battery for the first time, you must read the information in "Installation and connection" – "General battery information".

- Connect the PowerUnit to the Electrobrush to provide a secure base for the vacuum cleaner.
- Swing the vacuum cleaner forward until the Electrobrush connector audibly clicks into place.
- Plug the supplied charging cable into the charging socket on the bottom of the battery.
- Plug the charger into a power socket.

The charging process will start.

You can read more about this in “Battery charging state indicator (while charging)”.

Charging the battery (with wall mounting) (Fig. 12)

There are 2 ways to store and charge the vacuum cleaner in the supplied wall bracket.

Before charging the battery for the first time, you must read the information in “Installation and connection” – “General battery information”.

You will need a suitable location near a free power socket for mounting the appliance on the wall.

Wall mounting (Figs. 13 + 14)

The supplied wall bracket has a mounting plate with a bag of screws attached to the back.

Attach the mounting plate to the point on the wall where you want the wall mounting to be.

- Remove the bag of screws.
- Press the release catch at the bottom of the wall bracket (Fig. 13).
- Remove the mounting plate from the wall bracket by sliding it downward (Fig. 14).

Attaching the mounting plate (Figs. 15 + 16)

2 plugs and 2 T20 TORX screws are supplied for attaching the mounting plate to the wall.

You will also need a battery-operated screwdriver or a drill (with a drilling diameter of 6 mm).

Depending on how you decide to configure your vacuum cleaner, select a distance of 17 11/16" or 38 9/16" (45 cm or 98 cm) between the bottom edge of the mounting plate and the floor (Fig. 15).

Be careful not to damage any electrical in the wall.

- Attach the mounting plate to the wall (Fig. 16).

Attaching the charging cable to the wall bracket (Figs. 17, 18, + 19)

A cable compartment is located on the underside of the wall bracket.

- Press both release catches on the underside of the wall bracket and remove the cable compartment cover (Fig. 17).
- Plug the supplied charging cable into the opening from above (Fig. 18).
- Lay the charging cable in its guide (Fig. 18).
- Refit the cover and close the cable compartment (Fig. 19).

Connecting the accessories holder (if required) (Fig. 20)

An accessories holder is supplied for storing the three-piece accessory set on the wall bracket (see “Using the accessories supplied”).

- Push the accessories holder on to the wall bracket as far as it will go.

Connecting the wall bracket
(Figs. 21 + 22)

- Slide the wall bracket down into the mounting plate from above until it audibly clicks into place (Fig. 21).
- Slide the PowerUnit of the fully assembled vacuum cleaner, with the battery inserted, down into the wall bracket from above (Fig. 22).
- Plug the charger into the power socket.

The charging process will start.

Battery charging state indicator
(while charging) (Fig. 23)

The battery charging state is displayed on the PowerUnit.

Battery life	Indicator
Approx. 0–34%	Bottom light flashes slowly
Approx. 35–69%	Bottom light is lit up; middle light flashes slowly
Approx. 70–90%	Bottom and middle lights are lit up; top light flashes slowly
Approx. 91–99%	Bottom, middle, and top lights are lit up
100%	Switches off

Once the battery is fully charged, the battery charging state indicator switches off to conserve energy.

If the battery has not been used for a long time and has run down, it will go into safe mode. As a result, the battery charging state indicator will only respond after approximately 30–60 minutes when charging in the PowerUnit.

Battery charging state indicator
(while in use) (Fig. 23)

The battery charging state is displayed on the PowerUnit.

Battery life	Indicator
Approx. 100–70%	Top, middle, and bottom lights are lit up
Approx. 69–35%	Middle and bottom lights are lit up
Approx. 34–15%	Bottom light is lit up
Approx. 14–0%	Bottom light flashes slowly

We recommend allowing the battery to run down completely before recharging it. In this way, you will benefit from the battery’s full capacity.

Using the accessories supplied (Fig. 24)

Miele offers a range of suitable accessories for many Special Modes (see “Optional accessories”).

- ① **Upholstery nozzle XL**
Accessory for cleaning upholstery, mattresses, and cushions.
- ② **Crevice nozzle**
Accessory for cleaning in folds, crevices, or corners.
- ③ **Dusting brush**
Accessory for vacuuming skirting boards, carved furniture, or ornaments.
The head can be swiveled to adjust the angle.
- ④ **Accessories holder for wall bracket**
For storing the three-piece accessory set.

Symbols on the holder show where to attach the different accessories. You can fit the accessories holder to the wall bracket (see “Installation and connection” – “Connecting the accessories holder”).

Accessories holder for the suction wand (Fig. 25)

This accessories holder allows you to carry around 2 accessories from the three-piece accessory set while you vacuum.

Multi Floor XXL Electrobrush (Fig. 26)

Follow the flooring manufacturer's cleaning and care instructions.

 Damage caused by trapped material.

Risk of the flooring getting scratched.

Make sure that there is no coarse dirt or debris trapped in the bottom of the Electrobrush, e.g., shards or stones.

The Electrobrush can be used for daily cleaning of carpets, rugs, and hard floors.

Tip: The suction wand is not a convenient option for cleaning carpeted stairs.

Tip: If you ever need to vacuum up substantial amounts of coarse dirt or debris, use the PowerUnit solo (see “Installation and connection” – “Using the PowerUnit solo”).

Hardfloor Care soft roller (HX HC) (Figs. 27 + 28)

(depending on model)

Follow the flooring manufacturer's cleaning and care instructions.

When fitted with the Hardfloor Care soft brush, the Electrobrush can be used to clean delicate hard floors.

Insert the Hardfloor Care soft brush into the Electrobrush instead of the roller brush fitted as standard (Fig. 28).

When you use the Hardfloor Care soft roller, the Electrobrush power consumption is automatically set to the optimum level – this can lead to a change in the operating noise.

- Unlock the flap on the side of the Electrobrush so that the  symbol becomes visible ①.
- Lift the flap up as far as it will go ②.
- Remove the roller brush that has been fitted as standard ③.
- Insert the Hardfloor Care soft roller.
- Close and lock the flap.

Electro Compact handheld brush (HX SEB) (Fig. 29)

(depending on model)

Follow the flooring manufacturer's cleaning and care instructions.

 Damage caused by trapped material.

Risk of the flooring getting scratched.

Make sure that there is no coarse dirt or debris trapped in the bottom of the handheld brush, e.g., shards or stones.

The handheld brush is particularly suitable for intensive cleaning of car seats and carpeted stairs.

For optimum cleaning results on upholstery, use the upholstery nozzle XL.

Tip: The suction wand is not a convenient option for cleaning car seats or stairs.

Tip: If you ever need to vacuum up substantial amounts of coarse dirt or debris, use the PowerUnit solo (see "Installation and connection" – "Using the PowerUnit solo").

Additional battery (HX LA)

(depending on model)

Using the additional battery doubles the amount of time the vacuum cleaner can be used for.

Before charging for the first time, please note the information in "Installation and connection" – "General battery information".

Battery charger cradle (HX LS) (Fig. 30)

(depending on model)

Before charging for the first time, please note the information in "Installation and connection" – "General battery information".

When charging the battery for the first time, you must use the PowerUnit. As of the second charging operation, you can use the battery charger cradle instead.

- Push the battery into the charger cradle until it audibly clicks into place.
- Insert the plug into a power socket.

The charging process will start. The battery charging state indicator flashes on the left.

You can find out more about the battery charging state indicator in "Installation and connection" – "Battery charging state indicator".

If you place the run-down battery in the charger cradle straight after use, it will only start charging once the battery has cooled down.

The cooling process can take up to 60 minutes. The battery charging state indicator on the charger cradle will not respond during this time.

Use

Switching on and off (Fig. 31)

- If you have charged the battery in the wall bracket, take the vacuum cleaner out of the wall bracket.
- If you have charged the battery directly, unplug the charging plug from the charging socket on the bottom of the battery.

For the best possible cleaning results, always activate the ComfortClean function before switching on the vacuum cleaner (see “Maintenance” – “Activating the ComfortClean function”).

- Press the On/Off switch on the Comfort handle ①.

Regulating the suction power (Fig. 31)

The suction power can be regulated to suit the type of flooring being cleaned. Reducing the suction power reduces the amount of effort required to maneuver the Electrobrush.

There are 3 power levels to choose from on the Comfort handle:

Min.	Lowest power level for light soiling
Eco	Medium power level for normal soiling
Max.	Highest power level for heavy soiling

The floor covering detection function is activated at every power level.

The Electrobrush power consumption is automatically set to the optimum level based on the type of flooring and roller brush used – this can lead to a change in the operating noise.

Carpet care function

When the vacuum cleaner is not moving, the Electrobrush's power is automatically reduced after a few seconds to protect the floor.

Illuminating the work area

(depending on model)

The Electrobrush on your vacuum cleaner is equipped with BrilliantLight to illuminate the work area.

Self-standing function for short pauses in vacuuming

(For safety reasons, this function can only be used when the PowerUnit is fitted at the bottom of the vacuum cleaner)

If you are vacuuming with the PowerUnit fitted at the bottom of the vacuum cleaner, you can easily interrupt operation while the appliance is switched on.

- Swing the vacuum cleaner forwards until the Electrobrush connector audibly clicks into place.

The vacuum cleaner stays securely upright, the Electrobrush switches itself off and the battery is conserved.

If you then unlock the connector on the Electrobrush, the Electrobrush will switch on again.

Maintenance

 Risk of injury caused by rotating roller brush.

You can injure yourself on the rotating roller brush.

Switch the vacuum cleaner off before doing any maintenance work. Use the On/Off switch on the Comfort handle to do this.

It is recommended to use only genuine Miele accessories bearing the “ORIGINAL Miele” logo on the packaging. Only these will guarantee the optimum performance of your vacuum cleaner and the best possible cleaning results.

Please note that faults and damage caused by use of accessories which do not bear the “ORIGINAL Miele” logo on the packaging are not covered by the vacuum cleaner warranty.

Optional accessories

Original Miele accessories are available from the Miele Webshop, Miele Customer Service, and your Miele dealer.

Original Miele accessories are identified by the “ORIGINAL Miele” logo on the packaging.



With 3D4U, Miele also offers free accessories to download from your 3D printer (www.miele.com, Service, 3D4U).

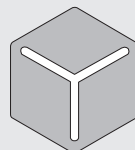

3 D 4 U

Filter system (Fig. 32)

- ① Fine dust filter (HX FSF-2)
- ② Pre-filter
- ③ Dust container
- ④ Dust container flap

Activating the ComfortClean function (Fig. 33)

Always run the interim cleaning function for the fine dust filter before emptying the dust container. You should also run it whenever the suction power begins to drop.

This enables the vacuum cleaner to achieve the very best cleaning performance again right away.

- The fine dust filter is located in the lid of the dust container. Twist it counter-clockwise by 3 180° turns. Use the recesses to help you.

You will hear an operating noise, which is a normal part of how the Comfort-Clean function works.

Emptying the dust container (Fig. 34–38)

Empty the dust container before the dust has reached the **MAX** marking on the dust container.

- Turn the lid of the dust container in the direction of the arrow as far as the first stop. Use the gray gripping surfaces to help you do this (Fig. 34).
- Remove the dust container upward (Fig. 35).

Provided that no prohibited substances are present, the contents of the dust container can be disposed of with normal household waste.

- Hold the dust container close to the trash can so that as little dust billows out as possible.
- Turn the lid of the dust container in the direction of the arrow as far as the next stop. Use the gray gripping surfaces to help you do this (Fig. 36).

The dust container flap will open and the dust will fall out (Fig. 37).

If chunks of dust, hair, or coarse debris do not fall out, remove the pre-filter by pulling it upward (see “Cleaning the pre-filter and fine dust filter” below).

- Turn the lid of the dust container back to its original position.
- Close the dust container flap, making sure it clicks into place.

- Slide the dust container handle along the guide line and down on to the PowerUnit connector from above until it audibly clicks into place (Fig. 38).

Cleaning the pre-filter and fine dust filter (Fig. 39–42)

Clean both filters thoroughly at least once every 3 months.

When cleaning them, it is essential to follow the steps in the order described.

- Remove the dust container.
- Empty the dust container over a garbage can.
- Turn the lid of the dust container beyond the stop until the arrow tips are aligned at the top ① (Fig. 39).
- Remove the pre-filter by pulling it upward ② (Fig. 39).
- Twist the fine dust filter counterclockwise by 10 180° turns. Use the recesses to help you (Fig. 33).

You will hear an operating noise, which is a normal part of how the Comfort-Clean function works.

- Twist the fine dust filter clockwise. Use the recesses to help you (Fig. 40).
- Remove the fine dust filter (Fig. 40).

 Risk of damage caused by incorrect cleaning.

The fine dust filter can become damaged and be less effective as a result.

Do not clean the fine dust filter with water and avoid cleaning the inside. Do not use pointed or sharp-edged objects to clean the filter. Do not brush the fine dust filter.

- Hold the fine dust filter over a garbage can.
- Carefully knock the fine dust filter with the rubberized lower edge.
- Turn the fine dust filter slightly while you do this to free the dirt from all of the crevices.

 Risk of damage caused by incorrect cleaning.

The pre-filter can become damaged and be less effective as a result.

Do not clean the pre-filter with water. Do not use pointed or sharp-edged objects to clean the filter.

- Clean the pre-filter with the dusting brush supplied or with a dry cloth.
- After cleaning the fine dust filter and pre-filter, reinsert the former into the latter by pressing the round cap on top of the fine dust filter down as far as it will go.

To continue achieving the best possible cleaning results, replace the fine dust filter (HX FSF-2) with a new one after approx. 3 years.

- Reinsert the pre-filter in the dust container (Fig. 41).

- To do this, line up the guides (arrows) and turn the pre-filter back to its original position (Fig. 42).

- Close the dust container flap, making sure it clicks into place.

- Replace the dust container on the PowerUnit connector.

Cleaning the dust container

Clean the dust container as required.

- Remove the dust container.
- Empty the dust container over a garbage can and lift the pre-filter upward to remove it (Fig. 39).
- Clean the dust container using water and mild detergent.
- Dry the dust container carefully.
- Reinsert the pre-filter in the dust container and turn the pre-filter back to its original position (Figs. 41 + 42).
- Replace the dust container on the PowerUnit connector.

Cleaning the Electrobrush/handheld brush (depending on model) (Fig. 43)

- Disconnect the Electrobrush/handheld brush from the vacuum cleaner (Fig. 10).
- Place the Electrobrush/handheld brush upside down on a level, clean surface.
- Use a pair of scissors to cut any threads or hairs that have wound themselves around the roller brush. To guide the scissors, move along the guide track on the roller brush.

Then run the vacuum cleaner to vacuum up the cut threads and hairs.

If the small running wheels are very heavily soiled or blocked, you can remove them for easier cleaning (not necessary in the case of the handheld brush). To remove them, use a flat-head screwdriver.

Follow the instructions regarding the handling and disposal of rechargeable batteries found in the following sections: “IMPORTANT SAFETY INSTRUCTIONS”, “Caring for the environment”, and “Installation and connection” (“General battery information”).

Removing the roller brush from the Electrobrush (Fig. 44)

(Not possible with the handheld brush)

You can take the roller brush out of the Electrobrush in order to remove stubborn soiling and clean the inside of the Electrobrush.

- Unlock the flap on the side of the Electrobrush so that the  symbol becomes visible ①.
- Lift the flap up as far as it will go ②.
- Remove the roller brush ③.
- Remove the roller brush handle if you identify heavy soiling there ④.
- Clean the roller brush and the roller brush handle, and remove any stubborn soiling inside the Electrobrush.
- Reassemble the Electrobrush in reverse order.

Replacing the rechargeable battery

An original Miele AP01/AP02/AP03 lithium-ion rechargeable battery (HX LA) is required.

Fault messages



Risk of injury caused by rotating roller brush.

You can injure yourself on the rotating roller brush.

Switch the vacuum cleaner off before dealing with any problems. Use the On/Off switch on the Comfort handle to do this.

Fault messages are displayed with a quick flashing light on the battery charging state indicator on the PowerUnit.

Problem	Possible cause and solution
Top light flashes quickly	<p>“Comfort handle not recognized” error</p> <ul style="list-style-type: none"> ■ Remove the Comfort handle and reconnect it (see “Installation and connection” – “Connecting the Comfort handle”). ■ Remove the battery, wait for 10 seconds, then reinsert it.
Middle light is flashing quickly	<p>“Motor overheating” error</p> <ul style="list-style-type: none"> ■ Empty and clean the dust container, pre-filter, and fine dust filter (see “Maintenance”). ■ Remove the battery, wait for 10 seconds, then reinsert it. ■ Wait for approximately 30 minutes before switching the vacuum cleaner back on again.
Bottom and top lights are flashing quickly	<p>Internal system fault</p> <ul style="list-style-type: none"> ■ Remove the battery, wait for 10 seconds, reinsert it, and charge it.
Bottom and middle lights flash quickly	<p>“Battery overheating” or “Battery not recognized” error</p> <ul style="list-style-type: none"> ■ Wait for approximately 30 minutes before switching the vacuum cleaner back on again. ■ Insert an original Miele AP01/AP02/AP03 lithium-ion rechargeable battery (HX LA).

Frequently Asked Questions

With the help of the following guide minor faults in the performance of the machine, some of which may result from incorrect operation, can be remedied without contacting the Service Department.

This guide may help you to find the reason for the fault, and how to correct it.



Risk of injury caused by rotating roller brush.

You can injure yourself on the rotating roller brush.

Switch the vacuum cleaner off before dealing with any problems. Use the On/Off switch on the Comfort handle to do this.

Problem	Possible cause and solution
The vacuum cleaner does not start when it is switched on.	There is no battery inserted or the battery is inserted incorrectly. <ul style="list-style-type: none"> ■ Insert the battery or check how the battery is positioned (see “Installation and connection” – “Inserting the battery”).
	The rechargeable battery is not sufficiently charged. <ul style="list-style-type: none"> ■ Charge the battery exactly as described in these operating instructions (see “Installation and connection” – “General battery information” and “Charging the battery”).
	An original Miele battery has not been inserted. <ul style="list-style-type: none"> ■ Insert an original Miele AP01/AP02/AP03 lithium-ion rechargeable battery (HX LA).
	The battery was not placed in the PowerUnit when charging it for the first time. <ul style="list-style-type: none"> ■ To activate the battery, it must be placed in the PowerUnit the first time it is charged (see “Installation and connection” – “General battery information” and “Charging the battery”).
	The charger is still plugged in. <ul style="list-style-type: none"> ■ Pull the plug out of the charging socket on the bottom of the battery.

Problem	Possible cause and solution
The cleaning performance is poor.	The dust container is full. ■ Empty and clean the dust container (see “Maintenance”).
	The Electrobrush is dirty/blocked. ■ Clean the Electrobrush (see “Maintenance” – “Cleaning the Electrobrush” and “Removing the roller brush from the Electrobrush”).
Cleaning performance is reduced.	The fine dust filter/pre-filter is soiled. ■ Run the interim cleaning function for the fine dust filter (see “Maintenance” – “Activating the ComfortClean function”). ■ Clean both filters thoroughly (see “Maintenance” – “Cleaning the pre-filter and fine dust filter”).
	The fine dust filter is worn. ■ Insert a new fine dust filter (HX FSF-2).
The roller brush is not rotating.	The roller brush is dirty. ■ Clean the roller brush (see “Maintenance” – “Cleaning the Electrobrush” and “Removing the roller brush from the Electrobrush”).
The operating noise is changing during vacuuming.	The Electrobrush power consumption is automatically set to the optimum level based on the type of flooring and roller brush used. ■ The noise is not unusual – the vacuum cleaner is functioning normally.
The Electrobrush switches itself off.	The Electrobrush is overloaded – this can happen on surfaces like deep-pile carpet. ■ Switch the vacuum cleaner off and switch it on again at a reduced suction power level. Use the On/Off switch on the Comfort handle to do this.
The vacuum cleaner keeps falling over.	You have configured the vacuum cleaner with the PowerUnit at the top. ■ Reassemble the vacuum cleaner so that it is configured with the PowerUnit at the bottom (see “Installation and connection” – “Assembling the vacuum cleaner”).

Customer Service

Contact in case of fault

In the event of a fault which you cannot remedy yourself, please contact your Miele dealer or Miele Service.

Contact information for Miele Service can be found at the end of this document.

Warranty

For more information about warranty conditions, please contact Miele Service.

Cleaning and care

 Risk of injury caused by rotating roller brush.

You can injure yourself on the rotating roller brush.

Switch the vacuum cleaner off before cleaning it. Use the On/Off switch on the Comfort handle to do this.

Vacuum cleaner and accessories

 Risk of electric shock from voltage.

If moisture gets into the charger, there is a risk of electric shock.

Do not let the charger get wet.

Follow the special cleaning instructions for the dust container in the "Maintenance" section.

The vacuum cleaner and all plastic accessories can be cleaned with a commercially available cleaner suitable for plastic.

 Damage due to unsuitable cleaning agents.

All surfaces are susceptible to scratching. Contact with unsuitable cleaning agents can alter or discolor the external surfaces.

Do not use abrasive cleaning agents, glass cleaning agents, all-purpose cleaners, or oil-based conditioning agents.

Optional accessories

Follow the flooring manufacturer's cleaning and care instructions.

It is recommended to use only genuine Miele accessories bearing the "ORIGINAL Miele" logo on the packaging. Only these will guarantee the optimum performance of your vacuum cleaner and the best possible cleaning results.

Please note that faults and damage caused by use of accessories which do not bear the "ORIGINAL Miele" logo on the packaging are not covered by the vacuum cleaner warranty.

Optional accessories

Original Miele accessories are available from the Miele Webshop, Miele Customer Service, and your Miele dealer.

Original Miele accessories are identified by the "ORIGINAL Miele" logo on the packaging.



With 3D4U, Miele also offers free accessories to download from your 3D printer (www.miele.com, Service, 3D4U).

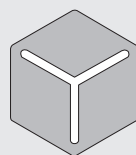

3 D 4 U

Certain models are supplied as standard with one or more of the following accessories.

Electro Compact handheld brush (HX SEB)

For intensive cleaning of car seats and carpeted stairs.

Hardfloor Care soft roller (HX HC)

For cleaning delicate hard floors.

Radiator brush (SHB 30)

For dusting radiators, narrow shelves and crevices.

Mattress tool (SMD 10)

For vacuuming upholstery, mattresses, cushions, curtains, covers, etc.

Crevice nozzle, 12" (300 mm) (SFD 10)

Extra long crevice nozzle for cleaning in folds, crevices and corners.

Crevice nozzle, 22" (560 mm) (SFD 20)

Flexible crevice nozzle for vacuuming hard to reach places.

AP01/AP02/AP03 additional battery (HX LA)

For doubling the amount of time the vacuum cleaner can be used for.

Before charging for the first time, please note the information in “Installation and connection” – “General battery information”.

LS03 (HX LS) battery charger cradle

For charging the additional battery independently of the appliance, i.e., while the appliance is in use.

Before charging for the first time, please note the information in “Installation and connection” – “General battery information”.

Fine dust filter (HX FSF-2)

To continue achieving the best possible cleaning results, replace the fine dust filter that is installed as standard with a new one after approx. 3 years (see “Maintenance” – “Cleaning the pre-filter and fine dust filter”).

en-US - LIMITED WARRANTY - Vacuum Cleaners USA

What This Warranty Covers and For What Period The Coverage Extends

Miele, Inc. (hereinafter "Miele") warrants to the original purchaser of this product, living in the United States of America, who purchased their vacuum from a Miele Authorized Dealer:

- a. That this product, including all of its Miele authorized parts is free of defects in material and workmanship.
- b. That this product, if found to be defective within the stated warranty period, will be repaired free of charge to the consumer (both parts and labor) by an authorized Miele service agent.
- c. The warranty period for vacuum cleaners, with the exception of "HomeCare" sub-models, is as follows:

Vacuum Series	Term
Classic Series Canister Vacuums	1 year
Swing Series H1 Vacuums	1 year
Compact Series Canister Vacuums	2 years
Scout Robotic Vacuums	2 years
Triflex HX1 Series Cordless Vacuums	2 years
Complete Series Canister Vacuums	3 years
Dynamic Series Upright Vacuums	3 years
Blizzard Bagless Series Canister Vacuums	3 years

- d. The warranty period for all "HomeCare" sub-model types is 5 (five) full years from the date of purchase, while the Triflex HX1 HomeCare is 3 (three) full years from the date of purchase.
- e. This warranty only applies while the product remains within the United States, and is null and void in any other US territories, possessions, or foreign countries.

Commercial Use

Vacuum cleaners other than the Scout RX1 and Scout RX2 used for commercial purposes will be warranted for a period of six (6) months from the date of purchase. There is no warranty for the Scout RX1 or Scout RX2 used for commercial purposes. Thereafter this Limited Warranty shall be null and void.

What is not covered by this Warranty

This warranty does not cover damage or defects caused by or resulting from repairs, service or alterations to the product or any of its parts or accessories which have been performed by service centers or repairmen not authorized by Miele, or damage or defects caused by negligence, accident, abuse, misuse, improper or abnormal usage or maintenance of the product, its parts or accessories, or damages caused by the use or installation of non-genuine Miele parts. Ordinary wear and tear or cosmetic damage (scuffs, scratches, gouges, dents, etc.) shall not be considered a defect in materials or workmanship.

Exclusion of Other Warranties

Except for the limited warranty provided herein, Miele disclaims any and all other express warranties with respect to the product. Any warranty of merchantability or fitness for a particular purpose is limited in its duration to the term of the limited warranty provided herein.

Some states do not allow limitations on how long an implied warranty lasts, so the above limitation may not apply to you.

Some states do not allow limitations on how long an implied warranty lasts, so the above limitation may not apply to you.

Limitation of Liability for Special, Incidental or Consequential Damages

Miele will assume no liability, or other obligation with respect to any personal injury or property damage resulting from the use of a vacuum cleaner, or its accessories, replacement parts, etc., which has not been purchased from, or serviced by an Authorized Miele Dealer. Any purchaser who obtains a vacuum cleaner, accessories, replacement parts, etc., from someone other than an Authorized Miele dealer proceeds at their own risk.

Miele specifically disclaims any and all liability, whether directly or by way of indemnity, for special incidental, consequential or other damages, whether based on breach of contract, tort, strict or product liability, or any other legal theory.

Some states do not allow the exclusion or limitation of incidental or consequential damages, so the above limitation may not apply to you.

Special State Laws

This Limited Warranty gives you specific legal rights; you may have other rights, which vary, from state to state.

Service

For service under this Limited Warranty, or to find an Authorized Miele Dealer in your area, please visit the "Find a Miele Partner Near You" section at Mieleusa.com.

Effective Date: July 20, 2020
©2020 Miele, Inc.

Veillez indiquer le modèle et le numéro de série de votre appareil lorsque vous contactez le service à la clientèle.

Canada

Importateur

Miele Limitée

Siège social au Canada et Centre Miele

161 Four Valley Drive
Vaughan, ON L4K 4V8
www.miele.ca

Service à la clientèle

Téléphone : 1-800-565-6435
customercare@miele.ca

Allemagne

Fabricant

Miele & Cie. KG
Carl-Miele-Straße 29
33332 Gütersloh

MIELE S.A. de C.V.**MIELE EXPERIENCE CENTER**

Arquímedes No. 43
Colonia Polanco Chapultepec
Alcaldía Miguel Hidalgo
C.P. 11560, Cd. de México

800 MIELE 00
info@miele.com.mx
www.miele.com.mx

Dirección del fabricante

Miele & Cie. KG
Carl-Miele-Straße 29
33332 Gütersloh
Alemania

Miele do Brasil

Alameda Gabriel Monteiro da Silva 819
Sao Paulo – SP – CEP 01441 000
Fone: (11) 3061-0430
Brasil

www.mielebrasil.com.br

Endereço do fabricante

Miele & Cie. KG
Carl-Miele-Straße 29
33332 Gütersloh
Alemanha

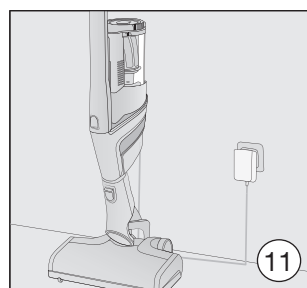
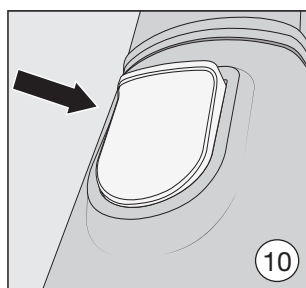
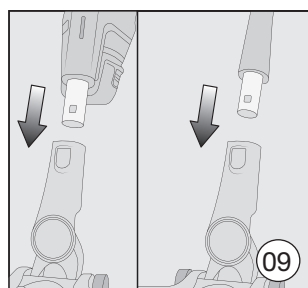
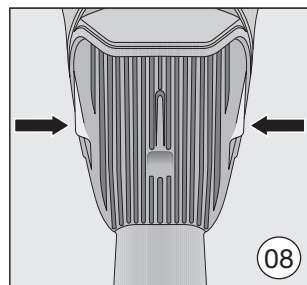
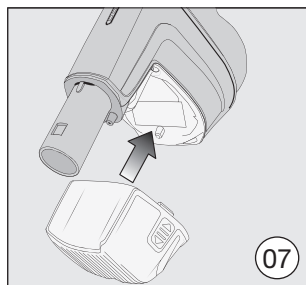
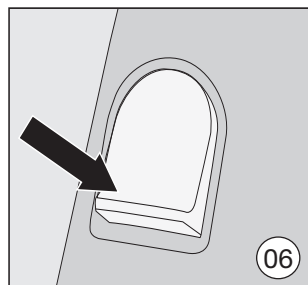
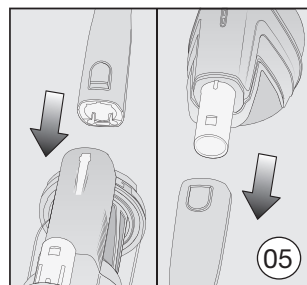
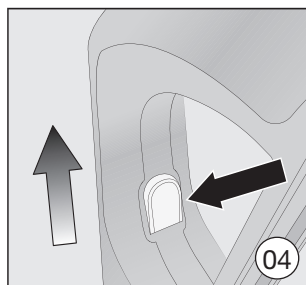
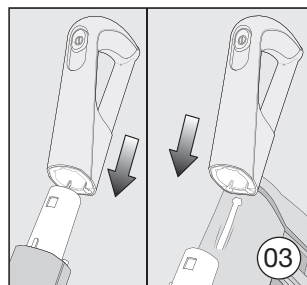
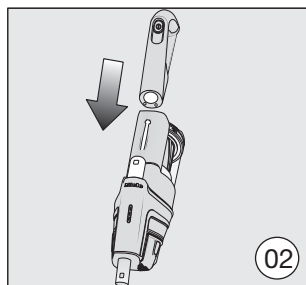
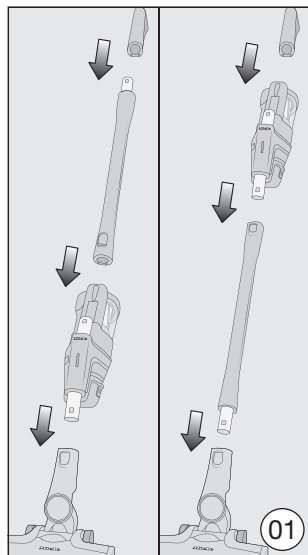

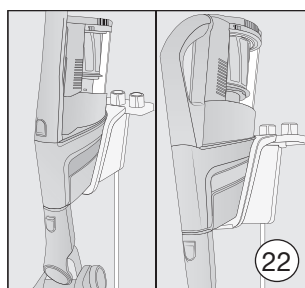
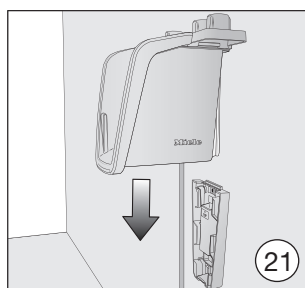
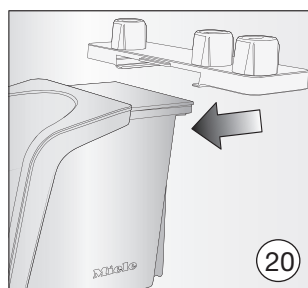
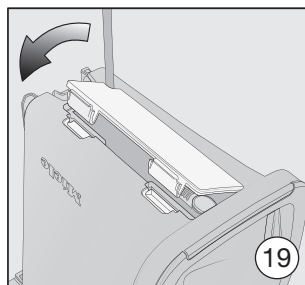
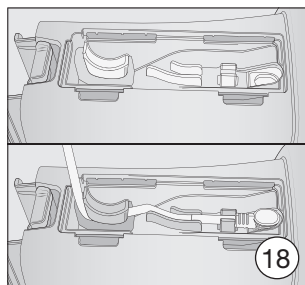
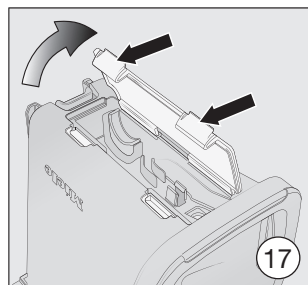
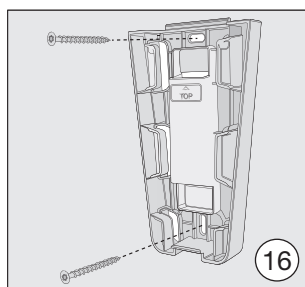
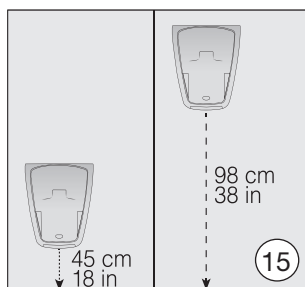
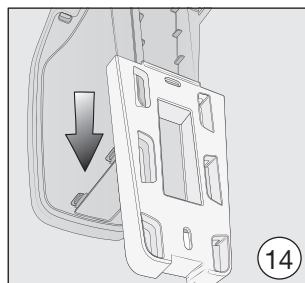
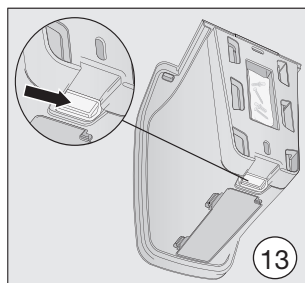
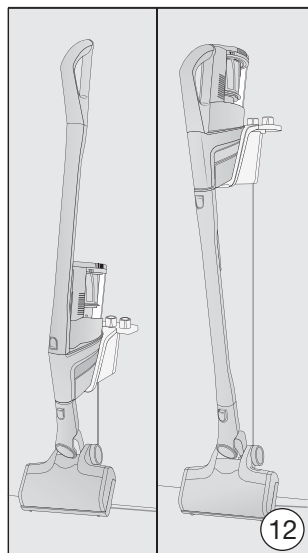

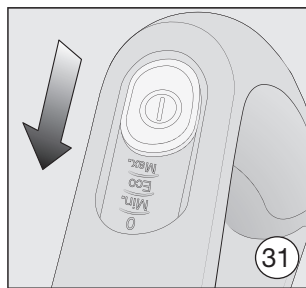
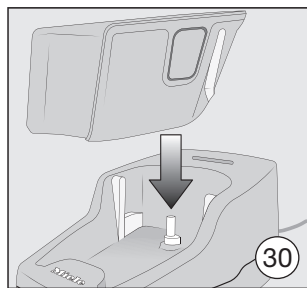
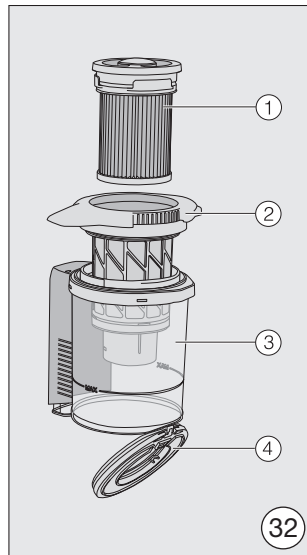
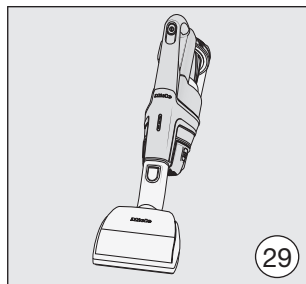
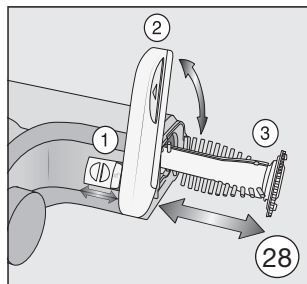
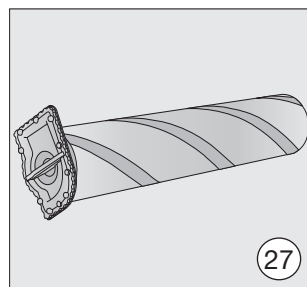
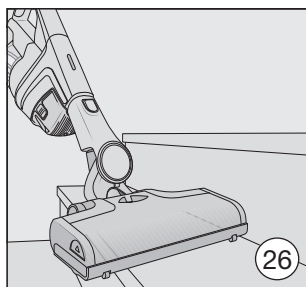
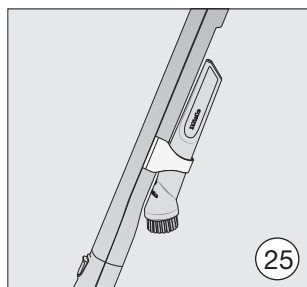
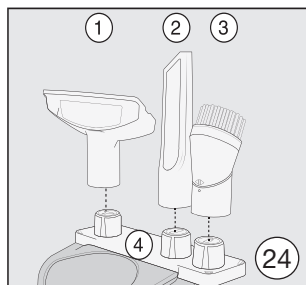
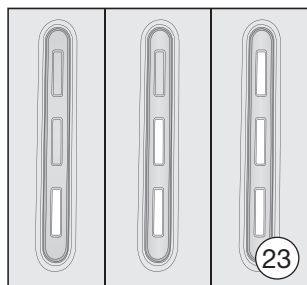

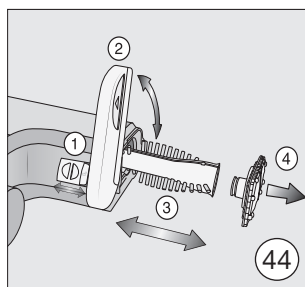
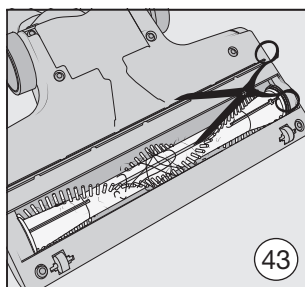
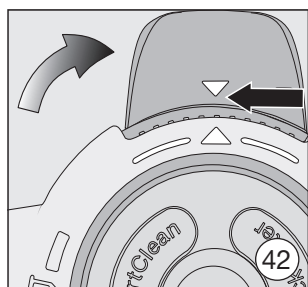
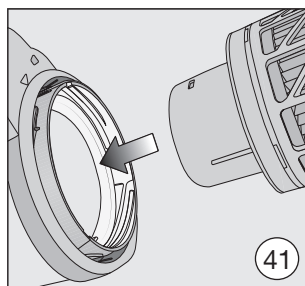
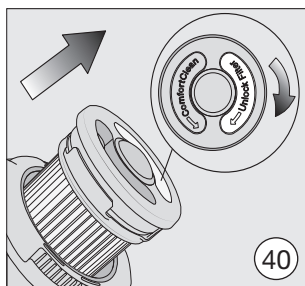
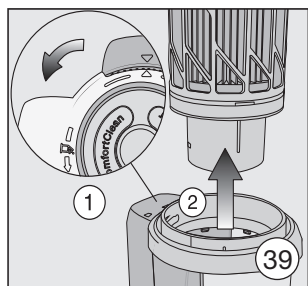
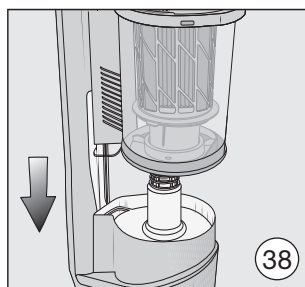
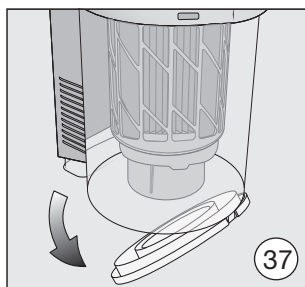
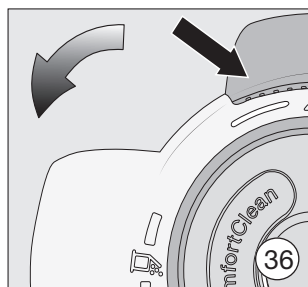
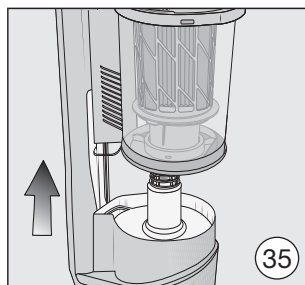
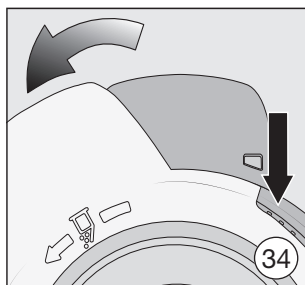
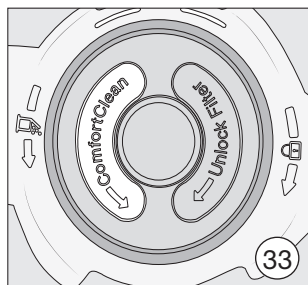

**Please have the model and serial number
of your appliance available when
contacting Customer Service.**

U.S.A.

Miele, Inc.

National Headquarters

9 Independence Way
Princeton, NJ 08540
www.mieleusa.com

Customer Support

Phone: 888-99-MIELE (64353)
info@mieleusa.com

International Headquarters

Miele & Cie. KG
Carl-Miele-Straße 29
33332 Gütersloh
Germany

Canada

**Importer
Miele Limited**

Headquarters and Miele Centre

161 Four Valley Drive
Vaughan, ON L4K 4V8
www.miele.ca

Customer Care Centre

Phone: 1-800-565-6435
905-532-2272
customercare@miele.ca