



**5**  
YEAR  
SATISFACTION  
GUARANTEE

**model UH200**

## **ULTRASONIC WHOLE ROOM HUMIDIFIER OWNER'S GUIDE**

GUÍA DEL PROPIETARIO DEL  
HUMIDIFICADOR Ultrasonico PARA  
AMBIENTES

GUIDE D'UTILISATION –  
HUMIDIFICATEUR À ULTRASONS POUR  
TOUTE LA PIÈCE

## **READ AND SAVE THESE INSTRUCTIONS**

LEER Y GUARDAR  
ESTAS INSTRUCCIONES

LISEZ ET CONSERVEZ CES  
INSTRUCTIONS

**vornado.com**

we expect  
this product  
to be **PERFECT**

if it's not,  
**WE** will make  
it right

vornado.com  
800.234.0604  
help@vornado.com

# CONTENTS

Important Safety Instructions .....	4	Mineral Cartridge .....	14
Getting Started .....	7	Automatic Refill Program.....	14
Features .....	8	Cleaning .....	15
Controls.....	9	Storage.....	18
Remote Control.....	10	Troubleshooting .....	19
Filling Water Tank.....	11	Warranty.....	21
How To Use .....	12	Español p. XX    Français p. XX	

# READ AND SAVE THESE INSTRUCTIONS

## IMPORTANT SAFETY INSTRUCTIONS

This owner's guide and any additional inserts are considered part of the product. They contain important information about safety, use and disposal. Before using the product, please familiarize yourself with all operating and safety instructions. Please keep all documents for future reference and pass these documents on, together with the product, to any future owner. See our website to view, download and print the most current version of this owner's guide.

**INTENDED USE:** This product is intended to humidify and circulate the air in indoor living spaces only in the United States and Canada. This product is not intended for commercial or industrial use. The manufacturer assumes no responsibility for damage or injury due to unauthorized use or product modification. Failure to follow these directions will void the product warranty.

### WARNING: Risk to Children and Impaired Persons

- Supervision is required during the installation, operation, cleaning and maintenance of this product by children age 12 years and younger and anyone with reduced physical, sensory or mental capabilities. Children should be supervised to ensure that they do not play with the appliance, its parts and packaging material.

### INSTALLATION WARNING—To reduce risk of fire, electrical shock and injury to persons, observe the following:

- No part of this product (the appliance, power cord, plug, packaging, etc.) should be placed near furnaces, fireplaces, stoves or other high temperature heat sources. Do not use in a window, on an uneven or unstable surface, or near water.

- The appliance, power supply, power cord and plug cannot come into contact with water. Do not use this product on wet surfaces. Do not use this product in a bathtub or shower or position product where it may fall into a bathtub, laundry, swimming pool or other water container. Do not use this product outdoors or expose it to weather or elements.
- Do not run cord under carpeting. Do not cover cord with throw rugs, runners, or similar coverings. Do not route under furniture or appliances. Arrange cord away from traffic area and where it will not be tripped over. The cord should not hang over edges of counters or be placed where it can be crimped or closed in doors. Place appliance near an easily accessible outlet so the product can be unplugged quickly during an emergency.

### SAFE USE WARNING—To reduce risk of fire, electrical shock and injury to persons, observe the following:

- **WARNING:** To reduce likelihood of circuit overload, fire and electric shock, do not operate with a solid state speed device, such as a dimmer control switch.
- Do not operate unit if the unit has been dropped or damaged. Do not use this product if it has a damaged power cord or plug. To avoid risk of electrical shock, do not attempt to repair or replace parts. Only original replacement parts may be used. If the power cord is damaged, it must be replaced by the manufacturer, its service agent, or similarly qualified persons in order to avoid a hazard. Contact Vornado Consumer Service at 1-800-234-0604 (phone) or consumerservice@vornado.com (email) for further instructions about replacement and repair.
- Risk of fire. Your appliance may be equipped with a detachable power supply or a cord/plug with a safety device such as a fuse. Use only the power cord and plug provided.

- Before plugging power cord into electrical outlet, be sure that all electrical information on the rating label, including voltage, is compatible with your outlet's power supply.
- Never use the cord as a handle or otherwise yank, strain or stretch the power cord.
- While the product is plugged in, do not insert or allow foreign objects to enter any input or output opening as this may cause risk of electric shock or fire, or damage the product.
- A loose fit between wall outlet (receptacle) and plug may cause overheating and distortion of the plug. Discontinue use of the product in this outlet. Contact a qualified electrician to replace loose or worn outlets.
- This appliance has a polarized plug (one blade is wider than the other.) To reduce the risk of electrical shock, this plug is intended to fit in a polarized outlet only one way. If the plug does not fit fully in the outlet, reverse the plug. If it still does not fit, contact a qualified electrician. Do not attempt to defeat this safety feature.
- The product may be hot when in use. To avoid burns, do not let bare skin touch hot surfaces. Always allow appliance to cool at least 30 minutes before moving, refilling or emptying it. Empty all water and dry unit before storing.
- Before filling with water, moving, repositioning, servicing, cleaning and when not in use, use the product controls to turn off the power and then unplug. To disconnect from outlet, grasp and pull only the plug. Also, power off and unplug if the product will be left unattended for an extended period of time or during electrical storms.
- Electric shock can occur when liquid comes in contact with electricity. Be careful when removing the water tank and refilling to avoid electric shock. Do not pour water through the top Outlet Air Grille on the power head.

- Turn the humidifier off if the relative humidity exceeds 60%. Humidity levels above 60% may allow moisture to build up indoors and condense on surfaces, where microorganisms can settle and grow. For accurate readings, use a hygrometer which is available at most hardware stores and home centers.
- The Mist Outlet and Mist Tube must be used when operating this product. The Mist Outlet and Mist Tube can be removed for cleaning.

### SERVICING WARNING—To reduce risk of fire, electrical shock and injury to persons, observe the following:

- Clean your product regularly, only as is instructed in this manual. Prior to cleaning, turn off the power on your product and unplug. Do not use gasoline, thinners, solvents, ammonias or other chemicals for cleaning. Refer to the CLEANING instructions provided.
- Do not open appliance housing while product is plugged in. To avoid risk of shock, all service and/or repairs must be done by a Vornado Authorized Service Center.
- Protect against the growth of mold, mildew and other microorganisms by emptying the water tank immediately after each use. If water is left in the tank for longer than 8 hours, thoroughly clean and disinfect the unit as described in the section of this Owner's Guide referenced as "CLEANING".

### DISPOSAL WARNING

To reduce waste and environmental harm, observe the following:



**PACKAGE RECYCLING:** The packaging protects the appliance from transport damage. The packaging materials are selected from the point of view of their environmental

friendliness and disposal technology and are therefore recyclable. Dispose of all packaging materials in an environmentally responsible manner.

**NOTE:** This equipment has been tested and complies with the CFR 47 Part 18 FCC Rules. Operation is subject to the following two conditions: (1) This device may not cause harmful interference, and (2) this device must accept any interference received, including interference that may cause undesired operation.

These limits are designed to provide reasonable protection against harmful interference in a residential installation. This product generates, uses and can radiate radio frequency energy and, if not installed and used in accordance with the instructions, may cause harmful interference to radio communications. However, there is no guarantee that interference will not occur in a particular installation. If this product does cause harmful interference to radio or television reception, which can be determined by turning the product off and on, the user is encouraged to try to correct the interference by one or more of the following measures:

- Reorient or relocate the receiving antenna.
- Increase the separation between the equipment and receiver.
- Connect the equipment into an outlet on a circuit different from that to which the receiver is connected.
- Contact Vornado Consumer Service or the dealer or an experienced radio/TV technician for help.

This digital apparatus complies with Canadian ICES-001.

Changes or modifications not expressly approved by the party responsible for compliance could void the user's authority to operate the equipment.

**Supplier's FCC Declaration of Conformity**  
Unique Identifier: Vornado Model UH200  
Responsible Party: Vornado Air LLC  
Mailing Address : 415 E. 13th St., Andover, KS 67002  
Contact: [www.vornado.com](http://www.vornado.com)

This device contains license-exempt transmitter(s)/receiver(s) that comply with Innovation, Science and Economic Development Canada's license-exempt RSS(s). Operation is subject to the following two conditions:(1) This device may not cause interference.(2) This device must accept any interference, including interference that may cause undesired operation of the device.

**RF Exposure Statement:** This product complies with the FCC and IC RF exposure limit set forth for an uncontrolled environment and is safe for intended operation as described in this manual.

**BATTERY DISPOSAL:** Please dispose of batteries according to the local laws and regulations of your region, and while keeping them away from children. Some batteries may be recycled and accepted for disposal at your local recycling center. **DO NOT DISPOSE OF BATTERIES IN FIRE. BATTERIES MAY EXPLODE OR LEAK.** New and used batteries may cause injury. Keep new and used cells (or batteries) away from children.

## SAVE THESE INSTRUCTIONS

# GETTING STARTED

Before operating, ALWAYS reach under the humidifier and lift from the bottom. Before use, check appliance for visible damage. DO NOT USE if there is evidence of damage. If any damage is found, contact Vornado Air, LLC at 1-800-234-0604.



### Check for Leaks

Damage due to shipping may cause leaks in Base or Water Tank. A visual inspection may not reveal hairline fractures.

1. Place humidifier on a water-resistant surface.
2. Fill Water Tank with water to inspect for leaks.
3. Pour several cups of water into Base to inspect for leaks.

### Not Leaking?

Empty water from Base and install full Water Tank.

### Leaking?

In the slight chance your humidifier has leaks, contact Consumer Service and we will immediately replace damaged parts.

A humidifier is quite useful in supplying necessary moisture to dry air. It should be used with proper care to prevent overhumidification.



A good rule of thumb would be to gauge the condensation or frost on windows. Adjust your humidifier to a point where this condition is at a minimum. These adjustments should be made when major changes in outdoor temperatures occur.

Humidifiers can be placed in any living area that has a convenient location and provides distribution of the moist air to the living area. The measured output of a humidifier is based upon continuous operation at standard rating conditions. With normal variations of indoor and outdoor conditions, the humidistat-controlled humidifier will not run continuously at maximum output unless the controls are set to do so.

### INITIAL HUMIDITY REQUIREMENTS:

When initially installed or when placed in operation at the beginning of each season, the humidifier equipped with a humidistat may run constantly for a day or so and, thus, evaporate large quantities of moisture. When the home and its furnishings have absorbed moisture and become stabilized at the desired humidity level, the amount of water used will diminish and the humidifier operation will maintain the desired humidity level.

# FEATURES

## HUMIDISTAT

Reads humidity in room for automatic humidity control.

## SIMPLETANK™ SYSTEM

This Water Tank is easy to carry, fill, install, clean and view water level. Large 1.75-gallon capacity.

## CLEANING BRUSH

Used for cleaning the Base in hard to reach areas. Stored in Base.

## MINERAL CARTRIDGE

Removes minerals from the water, thereby softening the water and reducing harmful mineral buildup on the Transducer.

## WATER TANK CAP

Easy-to-remove Cap for convenient Water Tank refilling. The Gasket creates a waterproof seal between Cap and Water Tank.



## REMOTE

Convenience at your finger tips.

## REMOTE CRADLE

Convenient storage for your remote.

## AIR OUTLET GRILLE

Initiates Vornado's signature Vortex circulation. Removable for easy cleaning.

## MIST OUTLET

Moist air is dispersed through the Mist Outlet and projected into Vornado's signature Vortex beam of air - circulating the moist air throughout the entire room.

## POWER HEAD

Powerful motor circulates humidified air throughout whole room.

## BASE

Durable and easy to clean.

# CONTROLS

## CONTROL INTERFACE

Displays selected humidity % settings  
Timer and Fan Speeds.

Note: Once the selected humidity %, time or fan speed is selected, the Control Interface will default back to showing the selected humidity %.

## FAN SPEED

Enables you to select the fan speed for output volume. Offers HIGH, LOW, or AUTO.

## LIGHT ADJUSTMENT

Changes LED light brightness between HIGH, MEDIUM and LOW. Lights dim after 20 seconds.

## WARM MIST

Red LED light indicates WARM MIST activated.

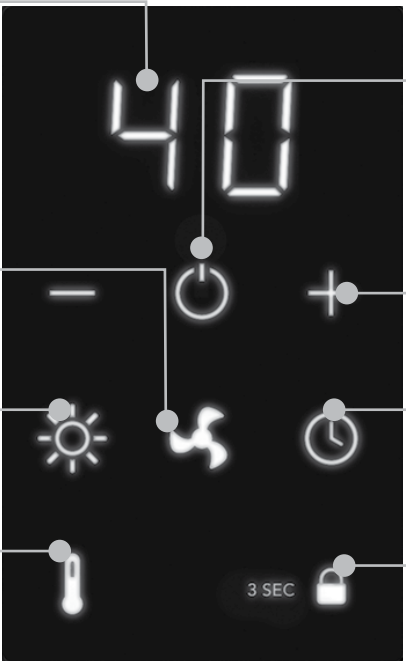

## POWER BUTTON

Easily operate with power button that turns humidifier On/Off. Flashes RED for 30 seconds when low water before auto shutoff.

## DECREASE/INCREASE (-/+)

Control humidity setting between 40%-60% or Continuous Mode and controls Timer increments.

## TIMER

Set timer up to 8 hours. BLUE LED light indicates Timer is active. Display shows time in hours.

## CONTROLS LOCK

Lock the Control Panel. To lock or unlock, hold button for 3 seconds. Red LED light indicated control panel is locked.

# REMOTE CONTROL

This product comes with a remote control. The buttons on the Remote have the same function as the corresponding button on the Control Panel. See CONTROL PANEL section for more information.

NOTE: The Display Interface (A) on the Remote displays the humidity % level in the location of the remote. The Humidistat (B) on the Remote reads the humidity % level where the remote is located.

The remote control requires 2 AAA batteries (included but not installed). To install batteries, remove the cover located on the underside of the remote control. If necessary, clean the battery contacts and also those of the device prior to battery installation. Remove any plastic protection from the batteries. On the inside of the battery cover, there is a + and – sign indicating which direction you should insert your batteries. Ensure the batteries are installed correctly with regards to polarity. Then replace cover on the underside of the remote control.

ON FIRST USE: To sync the remote control to the product, hold the Power Button on the remote for 5 seconds.

For battery replacement, always use the correct size and grade of battery for this product.

Note: Remove batteries from the remote control when not in use for an extended period of time and always remove dead batteries immediately and replace with fresh. Do not store dead batteries in remote.

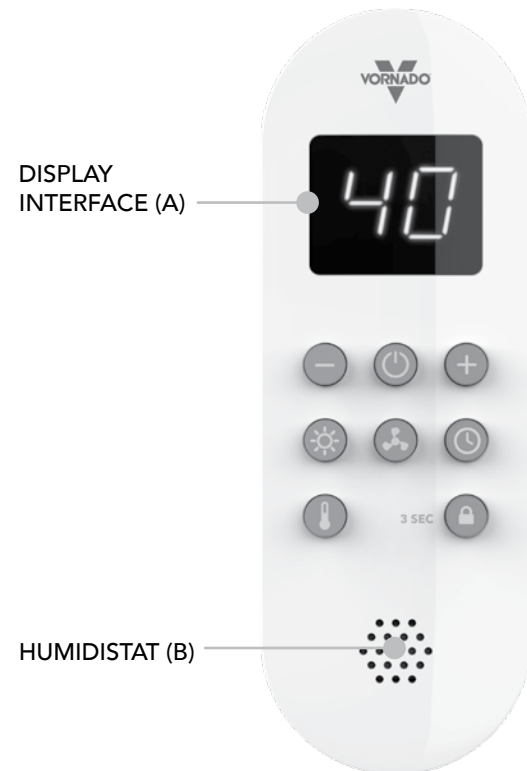

# FILLING WATER TANK

Before initial use, you must soak the Mineral Cartridge in water for 24 hours. You may use a separate container or Water Tank to do so. If Tank is used, empty water and refill with fresh water prior to use.

**Note:** Spills can occur during cleaning, moving or refilling the Water Tank, so be careful to avoid spills when doing these activities.

1. Unplug humidifier and place on a level surface.

Note: The unit may take several minutes to create mist with the initial use of a new Mineral Cartridge.

2. Remove Water Tank from the base by grasping the top integrated handle and pulling up towards you. **CAUTION: When removing Water Tank lift vertically, do not twist tank while still in base or Cap may disengage and leak.**

3. Turn the Water Tank upside down and remove the Cap by turning it counterclockwise.

4. Gently place Water Tank on a flat surface and fill with cool tap water.

5. Ensure Gasket, the rubber ring around the Water Tank, is properly positioned. Insert the Cap into the grooves of the tank and turn clockwise until tightened. When Cap is fully tightened the arrows on the tank will align with the indicator lines on the Cap.

6. Lower Water Tank into Base, positioning Water Tank around the ledge for secure placement. Once in nested position, water outlet valve inside Cap opens, releasing water into Base.

Note: The rate of water dispensing from Water Tank into Base is controlled by the Mineral Cartridge. The unit may take several minutes to fill the Base.

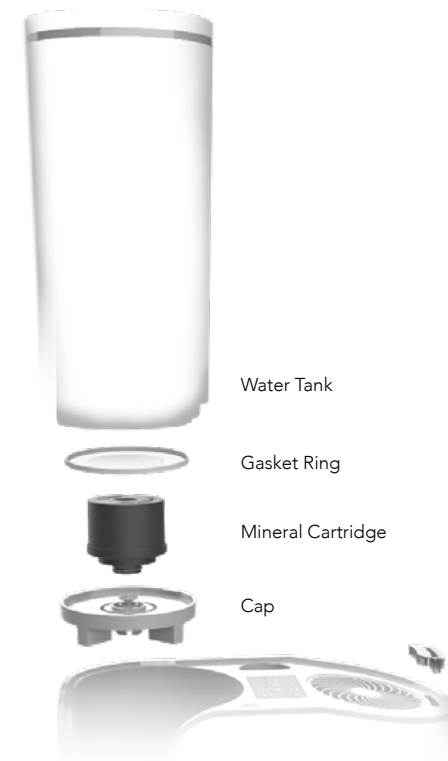

# HOW TO USE

1. Position humidifier to not blow directly on objects or plants. Plug power cord into standard grounded wall outlet. Remove tape from top of mist outlet prior to turning humidifier on.
2. To setup and use Remote Control, see “Remote Control” on page 10.
3. To turn humidifier on, press Power Button either on unit or remote. On first use, settings will default to HIGH Fan Speed, 50% humidity level and HIGH light brightness level. Humidity level settings are saved after power off and will return when powering back on. If unit is unplugged, during next use, settings will default to HIGH fan speed, 50% humidity level and HIGH light brightness.

4. Use FAN SPEED button on control panel or remote to select HIGH or LOW fan speed or AUTO mode until the desired setting shown on CONTROL INTERFACE.

**Note:** When Continuous humidity level is selected, the fan speed cannot be set to Auto and vice versa.

## HIGH FAN

Operation for fast humidification of larger rooms. HIGH fan speed with WARM Mist will have output of approximately 4.0 gallons of water in 24 hours of continuous operation. (This assumes room conditions of 70° F and 30% relative humidity.)

## LOW

Operation for quiet, nighttime use or smaller rooms. On Low operation, your humidifier may run without refilling for extended periods.

## AUTO

Operation for more precise humidity control. Fan speed and mist output will fluctuate to better maintain set humidity level with the minimal amount of fan noise. While in Auto, you will only be able to mode through humidity settings (40% - 60%). Continuous will be disabled.

Note: HIGH setting will be shown by ‘HI’, LOW setting will be shown by ‘LO’ and AUTO will be shown by “AU”. Setting will flash for 5 seconds, hold for 3 seconds then display selected humidity level.

5. To set TIMER, press TIMER button on control panel or remote and then INCREASE (+) or DECREASE (-) to set length of timer. TIMER icon is blue on control panel when activated.

6. To activate WARM MIST feature on, select WARM mist button on control or remote. When activated, icon on control panel will be RED.

**Note:** Lower humidity control settings or turn off humidifier if moisture forms on walls or windows.

# HOW TO USE



**CAUTION:** Use caution when handling humidifier after running on WARM Mist mode. Water in the base will be HOT. Wait 15 minutes for water to cool down before handling humidifier.

## HUMIDITY – 40%–60% OR CONTINUOUS

Set the humidity level by pressing the INCREASE (+) or DECREASE (–) BUTTON until the desired humidification level is shown on the control interface . The humidifier will operate until the desired humidity level is reached. At this point, the mist and fan will turn off. If the mist and fan do not turn on, the humidity setting may be lower than the room humidity level. Increase the humidity set point until the mist and fan turn on. This is an indication of the level of humidity already in the room. While in Continuous, you will only be able to mode through High and Low fan speeds before unit powers off. Auto mode will be disabled.

**Note:** When Continuous humidity level is selected, the fan speed cannot be set to Auto and vice versa.

7. When the LOCK CONTROLS button on the Control Panel or Remote is pressed and held for 3 seconds, the controls become locked from use and buttons will not function. To unlock, press and hold CONTROLS LOCK on Control Panel or Remote for 3 seconds. Pressing another button while Lock feature is active (indicated by red LED) will cause the Lock icon to flash.



# MINERAL CARTRIDGE

The Mineral Cartridge removes minerals from the water thereby softening the water and reducing harmful mineral buildup on the Transducer.

## WHEN TO REPLACE:

Many factors affect the frequency in which the Cartridge will need to be replaced including amount of use, water hardness, and outside environmental factors. For heavy use, using the unit continuously, we recommend replacing the Cartridge approximately once a month. For lighter use, using the unit intermittently, we recommend replacing the Cartridge every two months.

The Cartridge will need to be replaced earlier if white powder residue accumulates around the device. If the water used in the humidifier has been treated by a decalcification system, the salt from the treatment can show up as white dust also.

## HOW TO REPLACE:

1. Remove Water Tank.  
(See FILLING WATER TANK for instructions)
2. Unscrew Cap.
3. Unscrew Mineral Cartridge from Cap (A).  
Discard Cartridge.

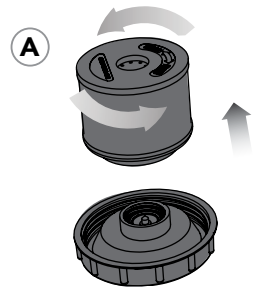

4. Install new Cartridge onto Cap.

**Note:** The unit may take several minutes to create mist with the initial use of a new Mineral Cartridge.

5. If storing unit, empty Water Tank and reinstall Cap. Replace Tank back into unit. See STORAGE.

## AUTOMATIC REFILL PROGRAM

Select the shipment interval and Vornado will send replacement Mineral Cartridges automatically. Eliminate the hassle of remembering to reorder. Maintain the high efficiency of your Vornado Humidifier. **To sign up**, visit [vornado.com](http://vornado.com), email [consumerservice@vornado.com](mailto:consumerservice@vornado.com) or call 1-800-234-0604. Cancel at anytime.

Part # MD1-0018

# CLEANING

Proper cleaning of your Ultrasonic Humidifier is essential to the air quality and performance of your humidifier. The frequency in which your humidifier will need to be cleaned will vary depending on use, water hardness and outside environmental factors. It is recommended, assuming average use, to thoroughly clean the unit several times throughout the season, or when algae, mineral deposits or other particles begin to form. **Note:** If the humidifier is turned Off with water in Base and not turned back on for 8 hours or longer, or if humidifier is not cleaned as recommended, you may experience some growth of algae or bacteria. These microorganisms may become airborne.

## TO CLEAN BASE

1. Turn humidifier Off and unplug.

**Warning:** Do not submerge humidifier top in water.

2. Remove Water Tank by lifting straight up. Remove Mist Outlet.

3. Remove the humidifier body from base.

4. Wipe the exterior of the humidifier with a soft, damp cloth if needed.

5. Empty the Base. Clean Base with warm water and a mild detergent.

6. Use brush stored at the bottom of the base

for hard to reach areas. Brush can be used to clean out any debris or residue left in the water trough.

7. Rinse and dry. Reassemble humidifier.

8. Prior to use, ensure that the outside of the coupler and surrounding area is completely dry.

**Note:** The Base is not dishwasher safe.

**CAUTION:** Use caution when handling humidifier after running on WARM Mist mode. Water in the base will be HOT. Wait 15 minutes for water to cool down before handling humidifier.





# CLEANING

**Note:** On occasion the Water Tank may need to be wiped down or cleaned to remove build-up of impurities with a mild detergent and cool water. Do not use gasoline, thinners, solvents or other chemicals for cleaning. The Water Tank is not dishwasher safe.

## TO CLEAN GRILLE

1. Turn humidifier Off and unplug.

**Note:** Do not use gasoline, thinners, solvents or other chemicals for cleaning.

2. Remove Mist Outlet. Using a Phillips Head screwdriver, remove screw located at 6 o'clock position inside grille. Twist grille counterclockwise to unlock, then use screwdriver to lift grille.
3. Clean the grille, blade or underside of motor with a soft cloth or with a can of compressed air.
4. Reinstall grille and twist grille clockwise until screw holes align. Replace screw.



## TO CLEAN MIST OUTLET

While you have the humidifier disassembled, if needed, rinse the Mist Outlet with clean tap water. Be sure the Mist Outlet is removed from the humidifier before cleaning. Ensure Mist Outlet attached before resuming operation.

# CLEANING

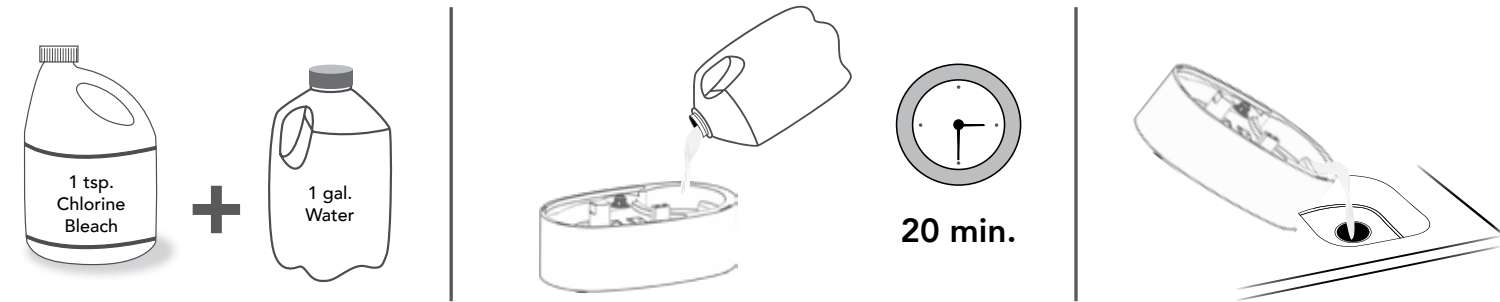

## IN THE EVENT YOU WANT TO DISINFECT THE BASE:

1. Mix solution of 1 teaspoon chlorine bleach and 1 gallon water. Fill Base with solution, wet all surfaces. Let stand 20 minutes, then empty.
2. Rinse Base with water until bleach smell is gone. Dry with clean cloth or paper towel.
3. You may also wipe down the entire surface of humidifier with a soft cloth.

# STORAGE

During the off-season or after extended periods of non-use, you may choose to store your humidifier. To ensure long life of the product, it is recommended to store your humidifier by following these instructions:

 Cleaning is recommended before storage.

- 1. Unplug power cord and bundle loosely.
- 2. Let humidifier dry completely before storing. Do not store with water inside Water Tank or Base.
- 3. Cover, or place back in retail carton if available. This will prevent humidifier from accumulating dust over time.
- 4. Store humidifier in cool and dry location.

# TIPS

Be aware of several things as your Vornado® Ultrasonic Whole Room Humidifier operates:

- If you operate your humidifier continuously (which is recommended to maintain humidity all day), it may need to be refilled with water every day. Check the Water Tank to be certain that there is an adequate water supply for operation.
- Allow for optimum airflow by keeping the grille unobstructed. Ensure curtains and other items are far enough away from the unit to not be pulled into the side inlets or interfere with airflow.
- Any additives, such as aroma fragrances or water conditioners, must not be used. These additives can cause cracks in the plastic of the humidifier and may affect performance. Any use of such additives voids the manufacturer's warranty.



## DISPOSAL

Dispose of all packaging materials in an environmentally responsible manner.

# TROUBLESHOOTING

PROBLEM	POSSIBLE CAUSE AND SOLUTION
Unit fails to power on.	Unit is not plugged in. Plug power cord into electrical outlet.  Household circuit breaker/ground fault circuit interrupter has tripped or blown fuse. Reset circuit breaker/ground fault circuit interrupter, or replace fuse. For assistance, see IMPORTANT INSTRUCTIONS.  Unit is damaged or in need of repair. Cease usage and unplug. Contact Consumer Service for assistance.
Unit makes bubbling or gurgling sound.	This is normal. Water is being dispensed into Base.
Unit is not producing desired amount of humidity or mist output has ceased.	Water level in Tank is empty or too low. Refill with clean, cool tap water. See HOW TO USE.  Unit has reached its set point. When set humidity level is reached, the unit will not produce mist until humidity level in the room drops below humidity set point.  Airflow is blocked. Remove obstruction.  Unit settings are too low. Set to High Output and Continuous Humidity for maximum humidity output.
White dust has accumulated on Mist Outlet or on flooring below.	Mineral Cartridge is no longer removing minerals from water. Cartridge needs to be replaced. See MINERAL CARTRIDGE.  Unit and Transducer is in need of cleaning. See CLEANING.  Water is too hard. Use distilled water.

# TROUBLESHOOTING

## PROBLEM

Remote control is not working.

## POSSIBLE CAUSE AND SOLUTION

The batteries are dead. Replace with 2 new AAA batteries. Refer to REMOTE CONTROL section for install instructions.

The batteries are not installed properly. Refer to REMOTE CONTROL section for install instructions.

The remote has not been synched to the product. To sync, hold Power Button on Remote control for 5 seconds.



# WARRANTY

We expect this product to be perfect. If you’re not satisfied with this product, let us know.

Vornado Air LLC (“Vornado”) warrants to the original consumer or purchaser this Vornado® Ultrasonic Whole Room Humidifier (“Product”) is free from defects in material or workmanship for a period of five (5) years from the date of purchase. If any such defect is discovered within the warranty period, Vornado, at its discretion, will repair or replace the Product at no cost.

**For warranty or repair service:**

Call 1-800-234-0604 or email [help@vornado.com](mailto:help@vornado.com) to obtain a Return Authorization (“RA”) form. Please have or include your Product’s model number and serial number, as well as your name, address, city, state, Zip code and phone number when contacting Vornado for warranty service.

**After receiving the RA form, ship your Product to:**

Vornado Air LLC Attn: Warranty & Repair 415 East 13th Street, Andover, KS 67002. For your convenience, please have your model number and serial number when contacting Vornado with service inquiries. To ensure proper handling, packages must be clearly marked with the RA number. Packages not clearly marked with the RA number may be refused at the receiving dock. Please allow 1–2 weeks for repair and return of your Product after the Product is received.

Repairs not covered by the warranty or outside the warranty period will require a fee to cover the cost of materials, labor, handling and shipping.

This warranty does not apply to defects resulting from abuse of the Product, modification, alteration, mishandling, improper maintenance, commercial use or repair or service of the Product by anyone other than Vornado; damages which occur in shipment or are attributed

to acts of God. Improper product use, which includes using an external device that alters or converts the voltage or frequency of electricity, or shipping a Vornado product to a country not intended for use will void all warranties. Any unauthorized product modification, repair by unauthorized repair center or use of non-approved replacement parts is not recommended and any consequences will not be covered by support services or product warranties. The product warranty will be honored only on models that are being used in the country intended. REPAIR OR REPLACEMENT AS PROVIDED UNDER THIS WARRANTY IS THE EXCLUSIVE REMEDY OF THE CONSUMER. VORNADO SHALL NOT BE LIABLE FOR ANY INCIDENTAL OR CONSEQUENTIAL DAMAGES FOR BREACH OF ANY EXPRESS OR IMPLIED WARRANTY ON THIS PRODUCT. EXCEPT TO THE EXTENT PROHIBITED BY APPLICABLE LAW, ANY IMPLIED WARRANTY OF MERCHANTABILITY OR FITNESS FOR A PARTICULAR PURPOSE ON THIS PRODUCT IS LIMITED IN DURATION TO THE DURATION OF THIS WARRANTY. Some states do not allow the exclusion or limitation of incidental or consequential damages, or allow limitations on how long an implied warranty lasts, so the above limitations or exclusions may not apply to you. This warranty gives you specific legal rights, and you may have other rights that vary from state to state. The manufacturer assumes no responsibility for damage or injury caused by failure to follow these instructions, improper product use or unauthorized product modifications. Any such actions will invalidate the product warranty.

All company names and product names are trademarks of their respective owners. ©All rights reserved. All technical information, data and instructions for the installation, connection and operation contained in these instructions for use correspond to the latest available information at time of printing. The contents of this manual may differ slightly from the actual product. Observe any additional supplements.

**We’re Here to Help**  
**800.234.0604**  
**vornado.com**  
**help@vornado.com**



Designed, engineered and supported in USA.

© 2020 Vornado Air LLC Andover, KS 67002. Patent pending. Specifications subject to change without notice. Vornado® is a trademark owned by Vornado Air LLC.



Vornado Air, LLC  
415 East 13th Street, Andover, Kansas 67002  
800.234.0604 | [vornado.com](http://vornado.com)