

For questions about features, operation/performance, parts, or service, call: **1-800-207-1156**.
In Canada, for assistance, installation, or service, call: **1-800-207-1156**.

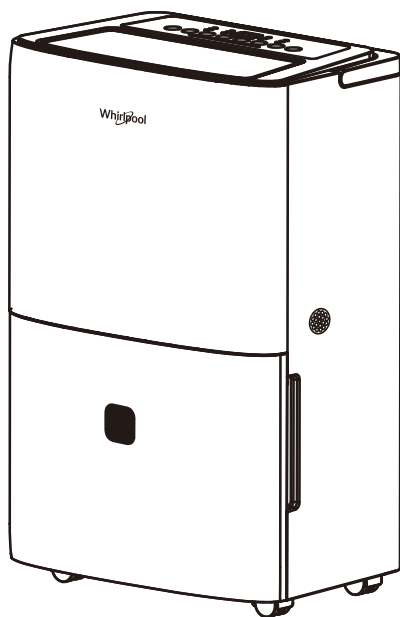

Model: **WHHD501PAW**

©/™ ©2025 Whirlpool. All rights reserved. Manufactured under license by XLS Products, Pennsylvania. Limited warranty provided by XLS Products.
Tous droits réservés. Fabriqué sous licence par XLS Products, Pennsylvanie. Garantie limitée fournie par XLS Products.
Todos los derechos reservados. Fabricado bajo licencia por XLS Products, Pennsylvania.

Table of Contents

DEHUMIDIFIER SAFETY	3	CARE AND CLEANING	14
INTRODUCTION TO REFRIGERANTS R32.....	4	TROUBLESHOOTING	15
INSTALLATION REQUIREMENTS	5	ASSISTANCE OR SERVICE	17
PARTS AND FEATURES	6	XLS PRODUCTS WARRANTY FOR	
USING YOUR DEHUMIDIFIER	9	WHIRLPOOL® DEHUMIDIFIERS	18

DEHUMIDIFIER SAFETY

Your safety and the safety of others is very important.

We have provided many important safety messages in this manual and on your appliance. Always read and obey all safety messages.



This is the safety alert symbol.

This symbol alerts you to potential hazards that can kill or hurt you and others.

All safety messages will follow the safety alert symbol and either the word "DANGER" or "WARNING."

These words mean:

⚠ DANGER

You can be killed or seriously injured if you don't immediately follow instructions.

⚠ WARNING

You can be killed or seriously injured if you don't follow instructions.

All safety messages will tell you what the potential hazard is, tell you how to reduce the chance of injury, and tell you what can happen if the instructions are not followed.



R32
A2L



R32
A2L



IMPORTANT SAFETY INSTRUCTIONS

WARNING: To reduce the risk of fire, electric shock, or injury when using your dehumidifier, follow these basic precautions:

- Plug into a grounded 3 prong outlet.
- Do not remove ground prong.
- Do not use an adapter.
- This appliance is not intended for use by people (including children) whose physical, sensory or mental capacities are different or impaired or who lack the necessary experience or knowledge/expertise to do so, unless such persons are supervised or are trained to operate the appliance by a person who accepts responsibility for their safety.
- Do not use an extension cord.
- Unplug dehumidifier before servicing.
- Use two or more people to move and install dehumidifier.
- Do not drink water collected in the water bucket.
- Children should be supervised to ensure that they do not play with the appliance.

SAVE THESE INSTRUCTIONS

INTRODUCTION TO REFRIGERANT R32

The refrigerant used in our dehumidifier is environmentally safe hydrocarbons. This kind of refrigerant is odorless and combustible, meaning it can burn and explode under certain circumstances. However, there is no danger of burning or exploding if you store in a well ventilated room without continuously operating flames or other potential ignition.

Compared to ordinary refrigerants, Refrigerant R32 is environmentally friendly, does not destroy the ozone, and has a very little value of greenhouse effect.

WARNING

- This appliance is for household use only.
- Please read the manual before installation, operation, and maintenance.
- Do not use means to accelerate the defrosting process or to clean, other than those recommended by the manufacturer.
- Do not pierce or burn the appliance.
- The appliance must be stored in a room without continuously operating ignition sources (for example: open flames, an operating gas appliance) and ignition sources (for example: an operating electric heater) close to the appliance.
- Please contact the nearest after-sale service center when maintenance is necessary. At the time of maintenance, the maintenance personnel must strictly comply with the Operation Manual provided by the corresponding manufacturer and any non-professional is prohibited to maintain the air conditioner.
- It is necessary to clear away the refrigerant in the system before maintaining or scrapping an air conditioner. Be aware the refrigerant may not contain an odor and is flammable.
- Keep ventilation openings clear of any obstruction.
- Any person who is involved with working on or breaking into a refrigerant circuit should hold a current valid certificate from an industry-accredited assessment authority, which monitors their competence to handle refrigerants safely in accordance with an industry recognized assessment specification.
- Always transport your appliance in a vertical position and place on a stable, level surface during use. If the unit is transported laying on its side, it should be stood up and left unplugged for at least 6 hours.

INSTALLATION REQUIREMENTS

Electrical Requirements—All Models

⚠ WARNING



Electrical Shock Hazard

Plug into a grounded 3 prong outlet.

Do not remove ground prong.

Do not use an adapter.

Do not use an extension cord.

Failure to follow these instructions can result in death, fire, or electrical shock.

The electrical ratings for your dehumidifier are listed on the model and serial number label. The serial number label is on the back of the dehumidifier cabinet.

Electrical Requirements

- 115 V (103.5 min.-126.5 max.)
- Operating current: 0A - 12A.
- Power socket: 15 A time-delay fuse or circuit-breaker.
- If there is a "Single Circuit Only" label on the rating label, please use on a dedicated single-outlet circuit only. If a dedicated single-outlet circuit is not available then it is the customer's responsibility to have a single-outlet circuit installed by a qualified electrician.

Recommended Grounding Method

This dehumidifier must be grounded. This dehumidifier is equipped with a power supply cord having a grounded 3-prong plug. To minimize possible shock hazard, the cord must be plugged into a mating, grounded 3-prong outlet, grounded in accordance with all local codes and ordinances. If a mating outlet is not available, it is the customer's responsibility to have a properly grounded 3-prong outlet installed by a qualified electrical installer. It is the customer's responsibility:

- To contact a qualified electrical installer.
- To assure that the electrical installation is adequate and in conformance with National Electrical Code, ANSI/NFPA 70 - latest edition, and all local codes and ordinances.

Copies of the standards listed may be obtained from:
National Fire Protection Association
1 Batterymarch Park
Quincy, MA 02269

Installation Instructions

⚠ WARNING

Excessive Weight Hazard

Use two or more people to move and install dehumidifier.

Failure to do so can result in back or other injury.

Remove Packaging Materials:

- Handle the dehumidifier gently while unpacking the unit.
- Remove the carton top and lift the dehumidifier from the base pad.
- Remove tape and glue residue from surfaces before turning on the dehumidifier. Rub a small amount of liquid dish soap over the adhesive with your fingers. Wipe with a damp cloth and dry.
- Do not use sharp instruments, rubbing alcohol, flammable fluids, or abrasive cleaners to remove tape or glue. These products can damage the surface of your dehumidifier.
- Dispose of or recycle packaging materials in an appropriate way.

Install The Hooks

1. Take the hooks out of the water bucket.

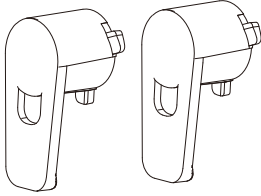

2. Install the hooks.

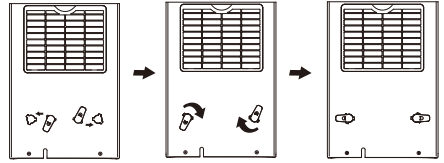

Put the hooks like above figure, and put them in the holes, then turn round about 45° clockwise.

3. Twisted power cord.

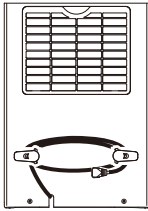

Before use, remove the accessories from the bucket

- Remove the bucket from appliance.
- Take out the plug and other accessories.
- Correctly put back the bucket into the appliance.

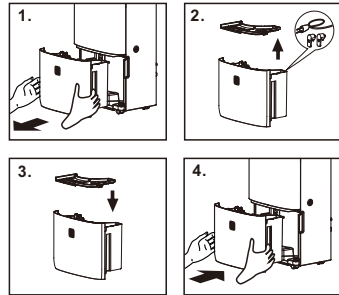

PARTS AND FEATURES

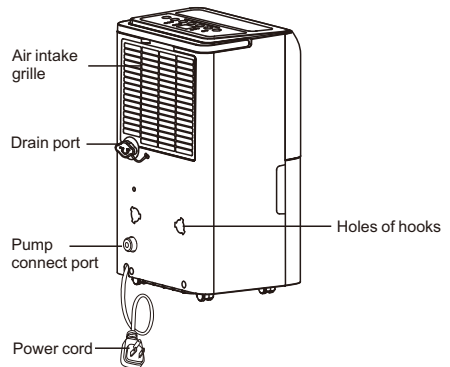
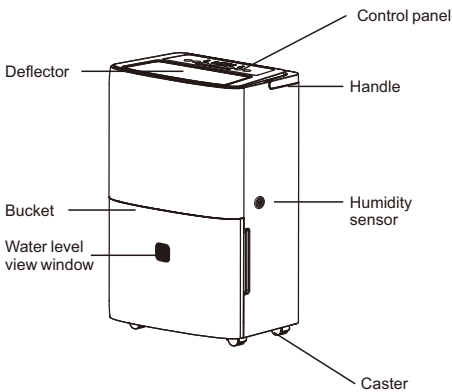

Placement

This dehumidifier must be placed on a stable, level, and solid floor that will support its weight with a full bucket of water. Allow at least 12-18" (30-45 cm) of clearance from walls and furniture. Do not allow the air inlet or outlet to be covered by drapes or curtains, as this will reduce performance.



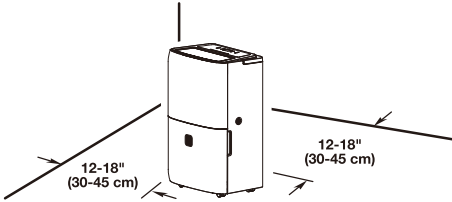

- Use the dehumidifier in an area where the temperature will not fall below 41°F (5°C).
- Use the dehumidifier in cooking, laundry, and dishwashing areas that have excessive moisture.
- Use the dehumidifier to prevent moisture damage anywhere books or valuables are stored.
- Use the dehumidifier in a basement to help prevent moisture.
- The dehumidifier must be operated in an enclosed area to be most effective.
- Close all doors, windows, and other outside openings in the room.

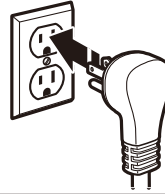

Plug into grounded 3 prong outlet



Packing List

APPEARANCE	PART NAME	QUANTITY
	Dehumidifier	1
	Drain pipe	1
	Hooks	2
	Pump drain connector and pipe (about 5m, 16.4 feet)	1

Electrical Connection

⚠ WARNING



Electrical Shock Hazard

Plug into a grounded 3 prong outlet.

Do not remove ground prong.

Do not use an adapter.

Do not use an extension cord.

Failure to follow these instructions can result in death, fire, or electrical shock.

Control Panel



Operating Instructions

You can easily operate this dehumidifier by press relevant button on the control panel .

Button icon

	Turn on/off the dehumidifier.
Mode	Switch between Dry/Laundry/Sleep mode.
	Adjust fan speed (Low, Med, High) Fan speed setting is available in Dry and Laundry, and Fan modes only.
	Increase the humidity setting or timer setting.
	Select to adjust the airflow direction by swinging.
	Timer button Press and hold 3 seconds to activate or cancel the Humidity indicator light.
	Decrease the humidity setting or timer setting.
	Turn on/off the water pump function.

Indicator icon

	Indicates the unit is in dry mode.
	Indicates the unit is in laundry mode.
	Indicates the unit is in sleep mode.
	Indicates the unit is in high fan speed.
	Indicates the unit is in med fan speed.
	Indicates the unit is in low fan speed.
	Indicates the water tank is full.
	Indicates the timer is setting.
	Indicates the deflector is swing.
	Indicates the pump is in service.
	Humidity indicator light

USING YOUR DEHUMIDIFIER

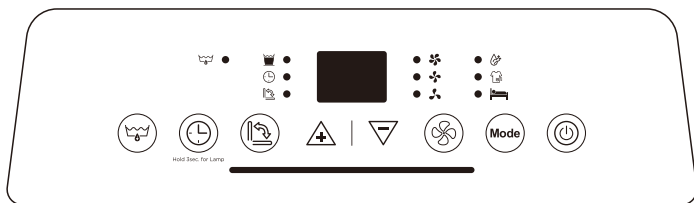

Turning the Dehumidifier On or Off

When you first plug in the dehumidifier, it will beep once and the display will show the current relative humidity level.

Press POWER to turn the dehumidifier on or off.

IMPORTANT:

- For optimal performance, when first operating the dehumidifier, run it in Continuous mode for 24 hours.
- If you turn off the dehumidifier, wait at least 3 minutes before turning it back on.
- Do not try to operate your dehumidifier if the temperature in the room is below 41°F (5°C) or above 90°F (32°C).

NOTE: In the event of a power failure, your dehumidifier will operate at the previous settings when the power is restored.

Selecting the Fan Speed

The Fan Speed has 3 settings:

- High—Maximum fan speed
- Med—Normal fan speed
- Low—Low fan speed

Press the FAN SPEED button until the indicator light turns on.

Selecting the Humidity Level

Press the up or down arrow button to increase or decrease the humidity setting. The relative humidity level can be adjusted between 35%RH and 80%RH.

Each press of the button will change the desired room humidity by 5%. The unit will cycle on and off to maintain the humidity level chosen on the digital display.

To operate the dehumidifier continuously regardless of the room humidity, press the Decrease button until you see "CO" on the digital display. This will enable continuous operation and the "Continuous" indicator will light up on the control panel.

Using the Timer

Auto Shut-Off

You can set the dehumidifier to shut off automatically after a set amount of time, up to 24 hours.

To set Auto Shut-Off:

1. With the dehumidifier on, press TIMER.
2. Press the up or down arrow button to increase or decrease the timer in 30-minute increments (0.5 hours) up to 10 hours. After 10 hours, each press of the button will increase the timer in one-hour increments up to 24 hours.
3. After the set time, the dehumidifier will turn off automatically.

Auto Start

You can set the timer to start the dehumidifier automatically after a set amount of time, up to 24 hours.

1. With the dehumidifier off, press TIMER.
2. Press the up or down arrow button to increase or decrease the timer in 30-minute increments (0.5 hours) up to 10 hours. After 10 hours, each press of the button will increase the timer in one-hour increments up to 24 hours.
3. After the set time, the dehumidifier will start automatically with the setting of 50%RH, low fan speed.

Preset Modes

Preset humidity level settings allow the user to easily move the dehumidifier from room to room. For optimum performance, select the corresponding mode for the location in which the dehumidifier is operating.

Press the MODE button to choose from Dry, Laundry, or Sleep.

Swing function

This function moves the deflectors to adjust the direction of the air flow.

To set this function correctly:

1. Press the SWING button to select the horizontal deflector to automatically move up and down.
2. Press the SWING button again to switch off this function.

Humidity light function

1. Press and hold the TIME button about 3 seconds to activate the Humidity light function.



Hold 3sec. for Lamp

Status	Damp	Comfortable	Dryness
Indicator color	Orange	Green	Blue
Humidity range	RH > 65%	45% ≤ RH ≤ 65%	RH < 45%

2. Press and hold the TIMER button about 3 seconds again to turn off the Humidity light function.

Bucket Full Indicator

When the water bucket is full of water, the unit will automatically shut off, make a beeping noise, and the Bucket Full Indicator will light up. See the "Emptying the Water Bucket" section for more information.



Automatic Defrost

If the dehumidifier operates for an extended time in low temperatures, ice may form on the cooling coils. If this happens, the dehumidifier compressor will turn off and the fan will run until the accumulated ice has melted. When the coils are completely defrosted, the compressor or fan (depending on the model) will automatically restart and dehumidification will resume.

Emptying the Water Bucket

⚠ WARNING

Sickness Hazard

Do not drink water collected in water bucket.
Doing so can result in sickness.

When the water collection bucket is full, the Bucket Full indicator will light and the dehumidifier will turn off. The dehumidifier will not function until the water bucket is emptied and replaced.

When the bucket is removed from the machine, the compressor will turn off, but the fan will continue to run for a few minutes. This is normal. The dehumidifier will not be removing moisture from the air at this time.

1. Remove water bucket

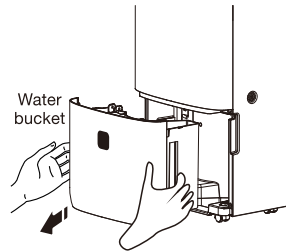

Remove the water bucket by pulling it straight out from the bottom front of the dehumidifier. The bucket features a convenient carry handle for easier transport.

NOTE: Do not place a full bucket on the floor, as the bottom is uneven and the bucket may tip.

2. Empty water bucket

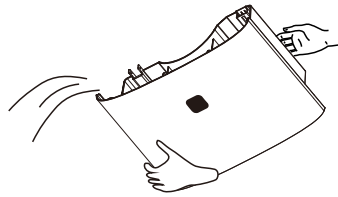

NOTE: Hold the bucket with both hands when emptying.

NOTE: When the bucket is full or removed from the unit, the compressor will turn off but the fan will continue to run for a few minutes. This is completely normal.

The unit will not be removing moisture from the air at this time.

NOTE: During operation, it is normal for the unit to exhaust warm air from the top of the unit.

CAUTION: Do not place the bucket on the floor when it is full as it is uneven on the bottom and water may spill.

Continuous Mode and Drain Hose Connection

The Continuous mode allows the unit to run continuously (depending on the selected humidity level) without having to empty the water bucket.

To drain continuously, attach a hose (not included) for water drainage into a floor drain.

The drain fitting uses a standard garden hose connector. The drain hose must be below the drain port on the back of the dehumidifier to ensure proper drainage.

NOTE: Use GHT or "garden hose thread", which has an outer diameter of 1¹/₁₆" (27 mm) and a pitch of 11.5 TPI (threads per inch).

1. Remove drain fitting plug

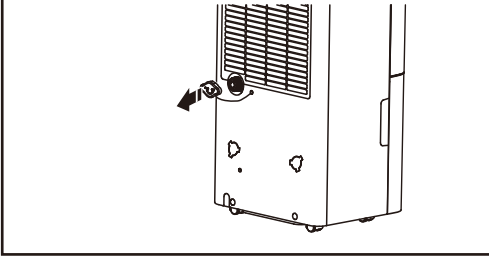

Place the dehumidifier on a level surface. Unscrew the cap on the back of the unit to access the drain fitting.

2. Install drain hose

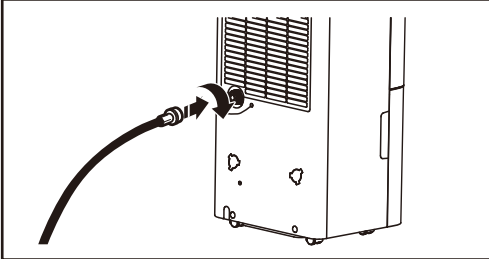

Thread the drain hose (not included) onto the drain fitting on the dehumidifier. Lead the rest of the hose to a floor drain and cut to length (no longer than 3.2 feet (1000mm) long). Make sure that there are no kinks or knots in the garden hose. Turn on the unit and press the  button until set to "CO" on the digital display.

Continuous Drain



Connect the drain pipe on the back of unit, then the unit will run continuously without the need for cleaning of the bucket.

1. Put the unit on level floor, unscrew the cap on the back of unit;
2. Install the drain pipe on connector;
3. Press POWER button to run the unit.

NOTE: If the continuous run function is not needed, install the drain cap back on the unit, then the water will flow into bucket.

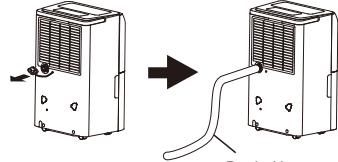

NOTE:

Please install the drain hose following the picture shown below. Please install the drain pipe correctly, or the water cannot drain from the pipe.

Please do not immerse the outlet of the drain pipe in water.

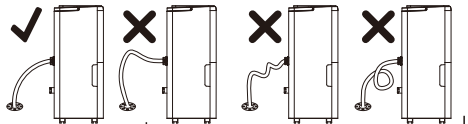

Correct

Incorrect

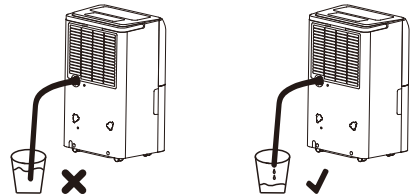

NOTE:

If the unit is placed on uneven ground or the drain pipe is not correctly installed, the water will fill the bucket and the unit will stop running. If this happens, please make sure the ground is level and the drain pipe is correctly installed.

The bucket will also need to be installed correctly.

Internal Pump Mode and Drain Hose Connection (optional)



Connect the pump drain pipe (16.4 ft (5 m)) on the back of unit, then the unit can continuous run without clean the bucket.

1. Put the unit on level floor.
2. Install the pump drain pipe with adaptor on back of unit.

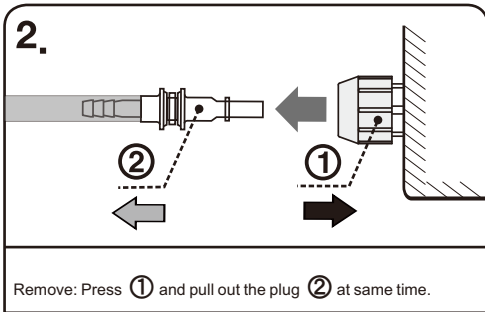
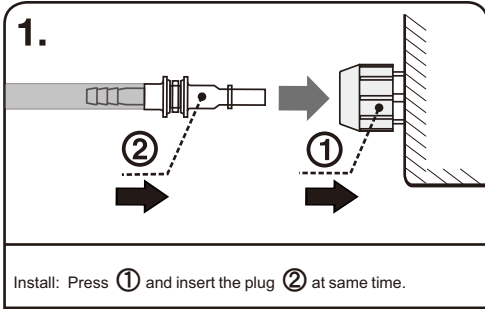

WARNING:

Do not pull the pipe ② or the plug ① forcefully directly!
Do not pull the pipe when using.

3. Press "⏻" button to run the unit, press the "🔊" button start the pump drain function, and the "PUMP" symbol is light up.
4. The max. height of pump drainage is about 16.4 ft (5m).

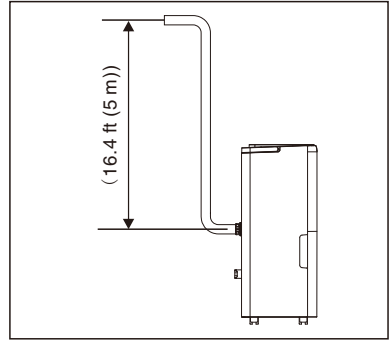

NOTE:

- After pump button has been activated, pump will not begin removing water, the pump will remain on stand-by. When internal bucket is almost full, pump will automatically begin removing water. This cycle will continue until pump button is deactivated.
- Make sure there are no kinks or knots in the hose.

Note: If there is full tank alarm, please clean the tank first, before start pump function.

⚠ WARNING

- Before the ambient temperature drops to 0°C (32°F), the condensate remaining in the appliance must be emptied to avoid damage to the machine.
- Please clean the condensate every month, avoid block pump, make the pump stop running.

Follow next step to emptied the condensate:

- 1) Remove the cover and plug to drainage water.
- 2) Install back the cover and plug on appliance.

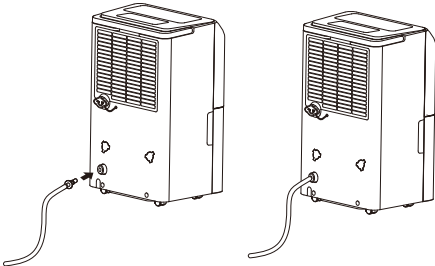
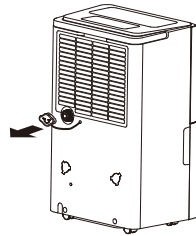

Continuous Drain



Connect the drain pipe on the back of unit, then the unit will run continuously without the need for cleaning of the bucket.

1. Put the unit on level floor, unscrew the cap on the back of unit;
2. Install the drain pipe on connector;
3. Press POWER button to run the unit.

NOTE: If the continuous run function is not needed, install the drain cap back on the unit, then the water will flow into bucket.

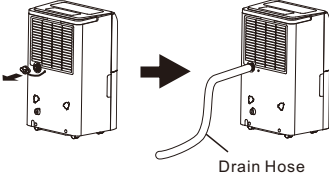

NOTE:

Please install the drain hose following the picture shown below. Please install the drain pipe correctly, or the water cannot drain from the pipe.

Please do not immerse the outlet of the drain pipe in water.

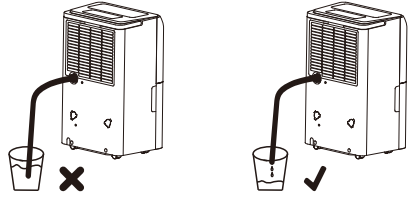
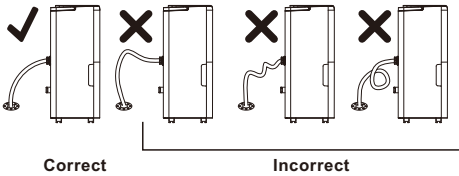

NOTE:

If the unit is placed on uneven ground or the drain pipe is not correctly installed, the water will fill the bucket and the unit will stop running.

If this happens, please make sure the ground is level and the drain pipe is correctly installed.

The bucket will also need to be installed correctly.

CARE AND CLEANING

Your new dehumidifier is designed to give you many years of dependable service. This section tells you how to clean and care for your dehumidifier properly.

Cleaning the Filter

The filter is removable for easy cleaning. A clean filter helps remove dust, lint, and other particles from the air and is important for best operating efficiency. Check the filter every two weeks to see whether it needs cleaning.

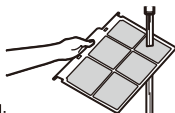

NOTE: For best performance, do not operate the dehumidifier without the filter in place.

Rinse the filter under the faucet. If the filter is very dirty, wash it in warm water with a mild detergent.

NOTE: Do not wash the filter in the dishwasher or use any chemical cleaners; it may damage the filter. Air dry the filter completely before replacing to ensure maximum efficiency.

Remove the filter

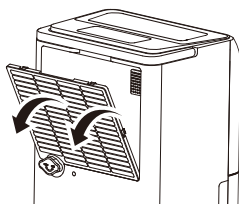

Remove the filter from back of the unit by using your thumbs to press down on the tabs directly above the filter.

Reinstalling the filter:

1. Wait until the filter is completely dry.
2. Reinstall the filter in the dehumidifier.
3. Press the Filter button to reset the filter indicator.

Cleaning the Dehumidifier Cabinet

1. Disconnect the power to dehumidifier.
2. Wipe the dehumidifier cabinet with a soft, damp cloth.
3. Wipe dry with soft cloth.

Cleaning the Water Bucket

Do not use wax, thinner, or a strong detergent. Do not use the unit in the presence of inflammable substance or vapor such as alcohol, insecticides, gasoline, etc

The water bucket should be cleaned every few weeks to prevent mold and mildew growth.

1. Remove the water bucket.
2. Wash the bucket with a mixture of warm water and a mild detergent.
3. Rinse well, then reinstall water bucket.

⚠ WARNING

Excessive Weight Hazard

Use two or more people to move and install dehumidifier.

Failure to do so can result in back or other injury.

Storing the Dehumidifier

If the dehumidifier will not be used for an extended period of time, prepare it for storage with the following steps.

1. Turn off the dehumidifier and unplug it.
2. Empty the bucket.
3. Remove, clean, and reinstall the filter.

TROUBLESHOOTING

Before calling for service, try the suggestions below to see whether you can solve your problem without outside help.

⚠ WARNING



Electrical Shock Hazard

Plug into a grounded 3 prong outlet.

Do not remove ground prong.

Do not use an adapter.

Do not use an extension cord.

Failure to follow these instructions can result in death, fire, or electrical shock.

PROBLEM	POSSIBLE CAUSES	RECOMMENDED SOLUTIONS
The dehumidifier will not start.	The dehumidifier is unplugged.	Make sure the power supply cord is plugged into a grounded 3 prong outlet. See the "Electrical Requirements" section.
	The fuse is blown/circuit breaker is tripped.	Check the house fuse/circuit breaker box and replace the fuse or reset the breaker. See the "Electrical Requirements" section.
	Power failure.	The unit will automatically restart when power is restored. There is a protective time delay (approximately 3 minutes) to prevent tripping of the compressor overload. The unit may not start normal cooling for 3 minutes after it is turned back on.
	The dehumidifier has reached a set humidity level or the bucket is full.	The dehumidifier automatically turns off when either condition occurs. Change to a lower humidity level or empty the water bucket and replace properly.
	The bucket is not in the proper position.	Securely seat the bucket in place.
The dehumidifier is not drying the air as it should.	Airflow is restricted.	Make sure there are no curtains, blinds, or furniture blocking the front of the dehumidifier.
	The humidity control is not set correctly.	Lower the set of humidity.
	The humidity control may be set too high.	For drier air, press the down arrow button to lower the percent humidity desired in the room, or set the dehumidifier to CO for maximum dehumidification.
	The room is too cool.	Moisture removal works best at higher room temperatures. Lower room temperatures will reduce the moisture removal rate. Your dehumidifier is designed to operate at temperatures above 41°F (5°C).
	Doors and windows are not closed tightly.	Check that all doors, windows, and other openings are securely closed.
	Clothes dryer may be blowing moist air into the room.	Install the dehumidifier away from the dryer. The dryer should be vented outside.
	The dehumidifier has just been installed.	When first installed, allow at least 24 hours to reach the desired dryness.
The dehumidifier runs too much.	The area to be dehumidified is too large.	The capacity of your dehumidifier may not be adequate for the room size.
	Doors and windows are open.	Close all doors and windows to the outside.

Frost appears on the Coils.	The dehumidifier has recently been turned on appliance run recently or the room temperature is too low.	This is normal. Frost will usually disappear within 60 minutes.
Controls cannot be set.	The compressor will turn off and the fan will automatically continue to run for approximately 3 minutes at a fixed setting.	This is normal. Wait approximately 3 minutes and set the fan speed at the desired level.
	Air is moving through the unit.	This is normal.
There is water on the floor.	Hose connection may be loose.	Check the hose connection and make sure it is tight. See the "Continuous Mode and Drain Hose Connection" section for more information.
	Hose is attached but not draining.	Make sure the hose is placed so that the water will flow into a drain. See the "Continuous Mode and Drain Hose Connection" section for more information.

If the following error code appears, please check the causes and solution.

CODE	DESCRIPTION	POSSIBLE CAUSES	SOLUTIONS
EH	Humidity sensor failure	Humidity sensor is damaged.	Connect customer service center.
E2	Temperature sensor failure	Temperature sensor is damaged.	Connect customer service center.
E3	Refrigerant leakage	E3 appears many times.	Connect customer service center.
E5	Pump error	Didn't install the pump drainage kit before start pump function.	Install the pump drainage kit, before start pump function.
		Users use non-standard drainage pipes. (Manufacturer's original pipe)	Use the original pipe.
		The drain cover is not tightened.	Tighten the cover.
		The rubber washer is missing.	Re-install the washer in cover.
		Poor connection between drain pipe and drain cover.	Check the connection of pipe and drain cover.

NOTE:

The code "E5" is only for pump model (WHAD50PDW).

Strictest operation environment: 41°F~90°F(5°C~32°C), 30%RH~90%RH.

ASSISTANCE OR SERVICE

Before calling for assistance or service, please check "Troubleshooting." It may save you the cost of a service call. If you still need help, follow the instructions below.

When calling, please know the purchase date and the complete model and serial number of your appliance. This information will help us to better respond to your request.

In the USA

Call XLS Products Customer Service toll free at 1-800-207-1156.

Our consultants provide assistance with:

- Features and specifications on our full line of appliances.
- Installation information.
- Use and maintenance procedures.
- Accessory and repair parts.
- Specialized customer assistance.
- Referrals to local dealers, repair parts distributors and service companies. XLS Products designated service technicians are trained to fulfill the product warranty and provide after-warranty service, anywhere in the United States.

For further assistance:

If you need further assistance, you can write to XLS Products with any questions or concerns at

XLS Products, Inc.
Customer Service
P.O. Box 16262
Philadelphia, PA 19114-0262

Please include a daytime phone number in your correspondence.

In Canada

Call the XLS Products Customer Service toll free at 1-800-207-1156.

Our consultants provide assistance with:

- Features and specifications on our full line of appliances.
- Use and maintenance procedures.
- Accessory and repair parts.
- Referrals to local dealers, repair parts distributors, and service companies. XLS Products designated service technicians are trained to fulfill the product warranty and provide after-warranty service, anywhere in Canada.

For further assistance:

If you need further assistance, you can write to XLS Products with any questions or concerns at

XLS Products, Inc.
Customer Service
P.O. Box 16262
Philadelphia, PA 19114-0262

Please include a daytime phone number in your correspondence.

XLS PRODUCTS WARRANTY FOR WHIRLPOOL® DEHUMIDIFIERS

ONE YEAR LIMITED WARRANTY

For one year from the date of purchase, when this product is operated and maintained according to instructions attached to or furnished with the product, XLS Products will pay for replacement parts and repair labor to correct defects in materials or workmanship or replace the product at our discretion. Service must be provided by a XLS Products designated service company. This warranty does not cover the air filter.

ITEMS XLS PRODUCTS WILL NOT PAY FOR

1. Service calls to correct the installation of your product, instruct you how to use your product, to replace house fuses or reset circuit breakers, replace or clean filters, or correct house wiring.
2. Service calls to repair or replace air filters. Those consumable parts are excluded from warranty coverage.
3. Repairs when your product is used for other than normal, single-family household use.
4. Damage resulting from accident, alteration, misuse, abuse, fire, flood, acts of God, improper installation, installation not in accordance with electrical or plumbing codes, or use of products not approved by XLS Products.
5. Replacement parts or repair labor costs for units operated outside the United States or Canada
6. Pickup and delivery. This product is designed to be repaired in the home.
7. Repairs to parts or systems resulting from unauthorized modifications made to the appliance.
8. Expenses for travel and transportation for product service in remote locations.
9. The removal and reinstallation of your appliance if it is installed in an inaccessible location or is not installed in accordance with published installation instructions.

DISCLAIMER OF IMPLIED WARRANTIES; LIMITATION OF REMEDIES

CUSTOMER'S SOLE AND EXCLUSIVE REMEDY UNDER THIS LIMITED WARRANTY SHALL BE PRODUCT REPAIR AS PROVIDED HEREIN. IMPLIED WARRANTIES, INCLUDING WARRANTIES OF MERCHANTABILITY OR FITNESS FOR A PARTICULAR PURPOSE, ARE LIMITED TO ONE YEAR OR THE SHORTEST PERIOD ALLOWED BY LAW. XLS PRODUCTS SHALL NOT BE LIABLE FOR INCIDENTAL OR CONSEQUENTIAL DAMAGES. SOME STATES AND PROVINCES DO NOT ALLOW THE EXCLUSION OR LIMITATION OF INCIDENTAL OR CONSEQUENTIAL DAMAGES, OR LIMITATIONS ON THE DURATION OF IMPLIED WARRANTIES OF MERCHANTABILITY OR FITNESS, SO THESE EXCLUSIONS OR LIMITATIONS MAY NOT APPLY TO YOU. THIS WARRANTY GIVES YOU SPECIFIC LEGAL RIGHTS AND YOU MAY ALSO HAVE OTHER RIGHTS, WHICH VARY, FROM STATE TO STATE OR PROVINCE TO PROVINCE.

Outside the 50 United States and Canada, this warranty does not apply. Contact your authorized XLS Products dealer to determine if another warranty applies.

If you need service, first see the "Troubleshooting" section of the Use & Care Guide. After checking "Troubleshooting," additional help can be found by checking the "Assistance or Service" section or by calling XLS Products. In the U.S.A., call 1-800-207-1156. In Canada, call 1-800-207-1156.

Keep this book and your sales slip together for future reference. You must provide proof of purchase or installation date for in-warranty service.

Write down the following information about your dehumidifier to better help you obtain assistance or service if you ever need it. You will need to know your complete model number and serial number. You can find this information on the model and serial number label located on the product.

Dealer name _____
Address _____
Phone number _____
Model number _____
Serial number _____
Purchase date _____