

Downblast Belt Drive Spun Aluminum Exhausters

ALX-DB SERIES

Ideal for exhausting air from factories, offices, warehouses or commercial buildings.

FEATURES

- Spun aluminum housing will not rust, chip or peel.
- Aluminum backward inclined wheel is non-overloading.
- Belt drive.
- Units up to 24" (max 2HP) can be wall mounted. All units can be roof mounted.
- Quick release latches for easy motor access.
- For motor options consult our fan selection software Delair. www.canarm.com/delair

OPTIONS & ACCESSORIES

- Motorized damper
- Gravity (automatic) damper
- Wall mount bracket (for all sizes up to 24")
- Roof curb
- Disconnect switch
- Hinge kits
- VFD for 3 phase motors
- Other base (curb cap) options available. See C2 in dimensions table.



AVAILABLE WITH MOTORS & DRIVES FACTORY INSTALLED.
Consult Delair Software for details



QUICK RELEASE LATCHES FOR EASY MOTOR ACCESS

DISCONNECT SWITCHES

Disconnect switches are available. See Controls & Thermostats section for details.



Intertek

705





ALX-DB SERIES Downblast Belt Drive Spun Aluminum Exhausters

PERFORMANCE SPECIFICATIONS

WITH MOTOR & DRIVES

MODEL	RPM RANGE	HP	RPM	Values @ 0.5" SP			0" SP				1/2" SP				1" SP				1-1/4" SP				1-1/2" SP					
				BHP	Sones	CFM	BHP	FEI	FEPact (kW)	CFM	BHP	FEI	FEPact (kW)	CFM	BHP	FEI	FEPact (kW)	CFM	BHP	FEI	FEPact (kW)	CFM	BHP	FEI	FEPact (kW)			
SINGLE PHASE AND WIRED DISCONNECT																												
ALX135DBT10025**	862-1293	1/4	1091	0.21	9.6	1423	0.17	-	-	1091	0.21	-	-	-	-	-	-	-	-	-	-	-	-	-	-	-	-	-
ALX135DBT10033**	932-1398	1/3	1255	0.29	12.9	1630	0.29	-	-	1285	0.29	-	-	-	-	-	-	-	-	-	-	-	-	-	-	-	-	-
ALX135DBT10050**	1121 - 1552	1/2	1380	0.39	16.3	1802	0.35	-	-	1501	0.39	-	-	1086	0.39	-	-	-	-	-	-	-	-	-	-	-	-	-
ALX150DBT10050**	932-1398	3/4	1039	0.30	12.4	1951	0.26	-	-	1497	0.30	-	-	-	-	-	-	-	-	-	-	-	-	-	-	-	-	-
ALX150DBT10075**	1078-1617	3/4	1222	0.48	17.6	2294	0.43	-	-	1920	0.48	-	-	1396	0.48	-	-	-	-	-	-	-	-	-	-	-	-	-
ALX150DBT10100	1113 - 1511	1	1318	0.59	23	2466	0.53	0.58	0.56	2132	0.59	0.95	0.61	1727	0.62	1.14	0.54	-	-	-	-	-	-	-	-	-	-	-
ALX165DBT10100	1097-1489	1	1250	0.64	21	2697	0.59	0.56	0.61	2243	0.64	0.92	0.66	1708	0.68	1.04	0.69	1301	0.66	1.01	0.67	-	-	-	-	-	-	-
ALX165DBT10150	1254-1646	1 1/2	1455	0.99	26	3143	0.93	0.42	0.92	2764	0.99	0.74	0.97	2330	1.05	0.90	1.03	2099	1.07	0.95	1.04	1802	1.08	0.95	1.05	-	-	-
ALX180DBT10100	909 - 1195	1	1176	0.90	21	3340	0.81	0.50	0.81	2894	0.90	0.83	0.89	2308	0.93	1.00	0.92	1911	0.92	1.01	0.91	-	-	-	-	-	-	-
ALX180DBT10200	1113 - 1511	2	1393	1.44	32	3969	1.44	0.34	1.37	3605	1.44	0.65	1.37	3145	1.56	0.81	1.47	2909	1.56	0.88	1.47	2638	1.56	0.92	1.47	-	-	-
ALX210DBT10150	862-1132	1 1/2	977	1.20	19.3	4852	1.21	0.48	1.17	4104	1.20	0.87	1.16	3130	1.16	1.06	1.12	2275	1.25	0.88	1.20	-	-	-	-	-	-	-
ALX245DBT10150	673-889	1 1/2	795	1.32	19.4	5969	1.30	0.53	1.24	4759	1.32	0.90	1.26	3063	1.17	1.03	1.13	-	-	-	-	-	-	-	-	-	-	-
ALX245DBT10200	745-979	2	867	1.71	22	6544	1.72	0.44	1.61	5404	1.71	0.79	1.60	4100	1.64	0.97	1.54	3078	1.47	1.03	1.13	-	-	-	-	-	-	-
ALX245DBT10300	862-1132	3	971	2.41	27	7265	2.35	0.36	2.14	6313	2.41	0.66	2.20	5251	2.37	0.86	2.16	4592	2.30	0.91	2.10	3703	2.14	0.92	1.97	-	-	-
THREE PHASE WITH NO DISCONNECT																												
ALX150DB30100*	1113 - 1511	1	1318	0.59	23	2466	0.53	0.60	0.54	2132	0.59	0.99	0.59	1727	0.62	1.18	0.62	-	-	-	-	-	-	-	-	-	-	-
ALX165DB30100*	1097-1489	1	1250	0.64	21	2697	0.59	0.58	0.59	2243	0.64	0.95	0.63	1708	0.68	1.08	0.67	1301	0.66	1.04	0.65	-	-	-	-	-	-	-
ALX165DB30150*	1254-1646	1 1/2	1455	0.99	26	3143	0.93	0.43	0.90	2764	0.99	0.75	0.95	2330	1.05	0.92	1.01	2099	1.07	0.96	1.03	1802	1.08	0.96	1.03	-	-	-
ALX180DB30100*	909 - 1195	1	1176	0.90	21	3340	0.81	0.51	0.78	2894	0.90	0.85	0.87	2308	0.93	1.02	0.89	1911	0.92	1.03	0.88	-	-	-	-	-	-	-
ALX180DB30200*	1113 - 1511	2	1393	1.44	32	3969	1.44	0.34	1.36	3605	1.44	0.65	1.36	3145	1.56	0.81	1.47	2909	1.56	0.88	1.47	2638	1.56	0.92	1.47	-	-	-
ALX210DB30150*	862-1132	1 1/2	977	1.20	19.3	4852	1.21	0.49	1.15	4104	1.20	0.88	1.14	3130	1.16	1.08	1.10	2275	1.25	0.90	1.18	-	-	-	-	-	-	-
ALX245DB30150*	673-889	1 1/2	795	1.32	19.4	5969	1.30	0.54	1.23	4759	1.32	0.91	1.25	3063	1.17	1.05	1.11	-	-	-	-	-	-	-	-	-	-	-
ALX245DB30200*	745-979	2	867	1.71	22	6544	1.72	0.44	1.61	5404	1.71	0.79	1.60	4100	1.64	0.97	1.54	3078	1.47	0.98	1.39	-	-	-	-	-	-	-
ALX245DB30300*	862-1132	3	971	2.41	27	7265	2.35	0.37	2.11	6313	2.41	0.67	2.16	5251	2.37	0.87	2.13	4592	2.30	0.93	2.07	3703	2.14	0.94	1.93	-	-	-

** 115V only. All other motors will be wired at high voltage.
For three phase motors, substitute "" with "M" for 230/460 volt (wired for 460V) or "P" for 575 volt

WITHOUT MOTOR & DRIVES

MODEL	MIN HP	MAX HP	MAX RPM	TYPICAL MAXIMUM CFM @ SP																								
				0" SP				1/2" SP				1" SP				1-1/2" SP				2"				2-1/4"				
				CFM	BHP	FEI	FEPact (kW)	CFM	BHP	FEI	FEPact (kW)	CFM	BHP	FEI	FEPact (kW)	CFM	BHP	FEI	FEPact (kW)	CFM	BHP	FEI	FEPact (kW)	CFM	BHP	FEI	FEPact (kW)	
ALX135-DB	-	3/4	1800	2200	0.64	0.45	0.66	1993	0.74	0.74	0.75	1681	0.74	0.95	0.75	1366	0.74	1.07	0.75	-	-	-	-	-	-	-	-	-
ALX150-DB	1/4	1	1800	2975	0.93	0.41	0.92	2689	0.98	0.73	0.96	2298	0.99	0.95	0.97	1851	0.97	1.07	0.95	-	-	-	-	-	-	-	-	-
ALX165-DB	1/4	2	1800	3880	1.76	0.28	1.64	3582	1.81	0.53	1.68	3244	1.91	0.69	1.77	2850	1.92	0.81	1.78	2451	1.98	0.86	1.83	2187	1.97	0.87	1.82	-
ALX180-DB	1/4	2	1500	4257	1.68	0.31	1.57	3929	1.76	0.58	1.64	3592	1.90	0.74	1.76	3052	1.92	0.86	1.78	2451	1.89	0.90	1.75	-	-	-	-	-
ALX210-DB	1/2	3	1300	6394	2.77	0.28	2.25	5903	2.83	0.54	2.55	5278	2.78	0.74	2.51	4551	2.74	0.88	2.48	3627	2.63	0.93	2.38	2830	2.42	0.89	2.20	-
ALX245-DB	1/2	5	1200	8955	4.43	0.24	3.90	8197	4.48	0.46	3.94	7374	4.50	0.63	3.96	6505	4.43	0.77	3.90	5405	4.25	0.84	3.75	4656	4.03	0.85	3.56	-

* Motor adaptor plate required for 3HP+

DIMENSIONS

MODEL	DIMENSIONS (INCHES)								Shaft Size	Wheel Diameter	Roof Opening	WEIGHT (lbs) without motors
	A	B	C	C2	D	E	F	G Ø				
ALX135-DB	25.25	31.25	21.00	24.75	3.13	2.00	3.75	0.44	3/4"	13.50	17.00	41
ALX150-DB	26.13	31.25	21.00	24.75	3.75	2.00	3.75	0.44	3/4"	15.00	17.00	43
ALX165-DB	31.13	36.25	24.75	28.00	5.00	2.00	4.00	0.44	3/4"	16.50	20.75	106
ALX180-DB	31.75	36.25	28.00	24.75	5.50	2.00	4.00	0.44	3/4"	18.25	20.75	114
ALX210-DB	36.25	43.75	33.13	40.00	5.25	2.50	4.00	0.44	1"	21.25	29.00	176
ALX245-DB	37.00	43.75	33.13	40.00	5.88	2.50	4.00	0.44	1"	24.50	29.00	181

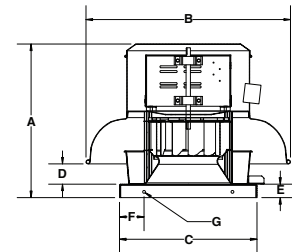

Net weights for belt drive units do not include motor & drives.
Due to motor manufacturers variances in design, please see user manual for motor dimensional guidelines.



SCAN TO VIEW FEI CHARTS



SCAN TO USE DELAIR SOFTWARE



Canam certifies that the ALX-DB Series shown herein are licensed to bear the AMCA Seal. The ratings shown are based on tests and procedures performed in accordance with AMCA Publications 211 & 311 and comply with the requirements of the AMCA Certified Ratings Programme.
The AMCA certified ratings seal applies to air and sound performance only. The ALX-DB Series shown herein are not approved by AMCA for FEI ratings.